

Executive Summary

West Virginia Department of Education Office of School Operations & Finance – School Facilities

Introduction: The Kanawha County Board of Education respectfully requests approval for the closure of George C. Weimer Elementary School and its consolidation into Alban Elementary School and Bridgeview Elementary School. This closure is not contingent upon any other actions, and it is proposed to occur at the end of the 2023-2024 school year.

Changes: The Kanawha County Board of Education requests approval of the following:

- The closure of George C. Weimer Elementary School and its consolidation into Alban Elementary School and Bridgeview Elementary School. This closure is not contingent upon any other actions, and it is proposed to occur at the end of the 2023-2024 school year. In consideration of this closure, applicable West Virginia State Board of Education policies were reviewed and followed. Documents were available for public inspection for the required amount of time, and a closure hearing was held for George C. Weimer Elementary School on May 4, 2023. Hearings for the receiving schools, Alban Elementary School and Bridgeview Elementary School were held on May 4, 2023. The Kanawha County Board of Education voted to approve this closure and consolidation at their board meeting at the conclusion of the hearing on May 4, 2023.

Impact: The consolidation of these schools will enable Kanawha County Schools to operate their schools more efficiently.



200 Elizabeth Street, Charleston, West Virginia 25311-2119 • (304) 348-7732 • Fax: (304) 348-7735
Thomas E. Williams, Jr., Ed.D., Superintendent

May 8, 2023

Mr. David Roach
State Superintendent of Schools
WV State Department of Education
1900 Kanawha Boulevard, East
Charleston, WV. 25305

Dear Mr. Roach:

The Kanawha County Board of Education voted unanimously on May 4, 2023, to close George C. Weimer Elementary and merge those students into Alban and Bridgeview Elementaries. The closure of George C. Weimer Elementary would be at the end of the 2023-2024 school year.

Kanawha County Schools is requesting approval of this closure/merger. Please add this agenda item to the June meeting of the State Board of Education.

Kanawha County Schools will also submit a request for an amendment to our current CEFP. I ask that this be placed on the June agenda as well. Supporting documentation is maintained and on file in the Facilities/Planning Office for Kanawha County Schools. Please let me know if you have additional questions.

Sincerely,

Thomas E. Williams, Jr., Ed.D.
Superintendent
Kanawha County Schools

Cc: Micah Whitlow, WVDE Director of School Facilities Services
Andy Neptune, Executive Director, SBA of WV
Andrew Crawford, Executive Director of KCS Facilities/Planning
Lindsey McIntosh, General Council, KCS

**REASONS AND SUPPORTING DATA
FOR THE
CLOSURE OF
GEORGE C. WEIMER ELEMENTARY SCHOOL
INTO
ALBAN ELEMENTARY SCHOOL
AND
BRIDGEVIEW ELEMENTARY SCHOOL**



George C. Weimer Elementary School



Alban Elementary School



Bridgeview Elementary School



REASONS AND SUPPORTING DATA
FOR THE
CLOSURE OF
GEORGE C. WEIMER ELEMENTARY SCHOOL
INTO
ALBAN ELEMENTARY SCHOOL AND
BRIDGEVIEW ELEMENTARY SCHOOL

KANAWHA COUNTY BOARD OF EDUCATION

Prepared Pursuant to

W. Va. Codes §18-5-13 and §18-5-13a and
WVBE Policies 6200 and 6204.

Kanawha County Schools
Under the direction and authority of
The West Virginia Board of Education (WVBE)

Public Hearing May 4, 2023
County Board Approval May 4, 2023

This template (revised 3/16/22) is provided by the WVDE as a technical assistance tool for county boards to use in the preparation of their supporting documents for a proposed school closure or consolidation. This template does not reduce or eliminate the requirements found in WV State Code or WVBE Policy 6204 as they relate to school closures or consolidations. This document does not replace or supplant legal assistance provided by counsel engaged to represent the county.

Table of Contents

3.0. County Procedures	2
3.2. Executive Summary	3
3.2.a Enrollment	5
3.2.b. Facilities	8
3.2.c. Finance	14
3.2.d. Personnel	17
3.2.e. Transportation	19
3.2.f. Educational Program	22
3.3. & 3.4. Public Notices and Hearings	23
3.6. County Board Actions	26
3.6.a. Superintendent Verification of Board Actions	27
Appendix of Supporting Data	28

3.0. County Procedures

WVDE Application for school closure and/or consolidation

Kanawha County

Closure of George C. Weimer Elementary School into Alban Elementary School and Bridgeview Elementary School

Scheduled Date of Hearing: Thursday, May 4, 2023 at 6:00 P.M.

Scheduled Date of County Board Vote: Thursday, May 4, 2023 following the Hearing

County Procedures

This template shall be used to accumulate and present the data that is requested in Policy 6204 and W.Va. Code 18-5-13a to support the closure or consolidation of a WV public school.

The county shall prepare written reasons and supporting data concerning proposed school closings or consolidations to be submitted to the WVBE for approval in accordance with this policy and W. Va. Code §18-5-13a. The written materials shall:

- be available for public inspection in the office of the county superintendent during the 30 days preceding the date of the public hearing; and*

Be delivered in duplicate to the:

- principal of a school that is proposed to be closed or consolidated, and of any school which the county designates to receive the students who are relocated as a result of the closure or consolidation; and*
- chair of the local school improvement council (LSIC) representing a school that is proposed to be closed or consolidated, and any school that the county designates to receive the students who are relocated as a result of the closure or consolidation.*
- A copy of the notice shall be posted at all schools, bus garages, and maintenance areas in the county in conspicuous working areas, for all professional and service personnel to observe.*

Thomas E. Williams, Jr., Ed.D.

See Appendix for this documentation

Superintendent

Date:

3.2. Executive Summary and Impact Statements

County Procedures

An executive summary shall be prepared including the following items that will summarize with page references to the county's documentation, as defined in section 3.1, those items listed and shall be provided to the WVDE School Facilities Services unit.

The Kanawha County Board of Education has experienced a loss in students over the past ten years. The overall student enrollment has decreased in enrollment by -15.5%. This represents a loss of 4,362 students from 2013/14 – 2022/23. In an effort to provide an equal and quality education to each student in Kanawha County Board the Kanawha County of Education proposes to consolidate services. This would not only save the Board of Education operating expense, but it would allow the county to provide an education curriculum that they currently cannot afford to provide all students.

The Kanawha County Board of Education proposes to merge George C. Weimer Elementary School to the existing Alban Elementary School and Bridgeview Elementary School, thus closing George C. Weimer Elementary School. The Merge would provide the following:

- The desire to meet the Economy of Scale guidelines of the SBA and the State Department of Education.
- Improving school transportation efficiency and complying with guidelines for length of bus rides for students to all facilities.
- Housing all students in permanently constructed facilities.
- Increasing the efficiency of operations of all facilities.

Enrollment 3.2.a.

Kanawha County has had a 14,944 decrease in population from 2010 through 2019. The student enrollment at George C. Weimer Elementary School has decreased by 34 students over the past ten years, and is projected to decrease by another 9 students over the next ten years. Alban Elementary School has decreased by 121 students over the past ten years, and is projected to decrease by another 38 students over the next ten years. Bridgeview Elementary School has decreased by 64 students over the past ten years, and is projected to decrease by another 40 students over the next ten years. The merger of George C. Weimer into these two schools would benefit all three student populations by decreasing the operating expenses and providing a better learning atmosphere and curriculum for students.

Facilities 3.2.b.

George C. Weimer Elementary School is 2.5 miles from Alban Elementary School, and 3.5 miles from Bridgeview Elementary School. George C. Elementary School is in average condition, but it is not ADA compliant. George C. Weimer has a 44.8% building utilization rate. Alban Elementary School is in average condition, with a 56.3% building utilization rate. Bridgeview Elementary School is in average condition, with a 67.0% building utilization rate. The existing facilities have been reviewed and evaluated during the recent CERP process. The SBA form 134 Worksheets are shown in the Appendix of Supporting Data. The space Utilization is also listed for each facility.

3.2. Executive Summary and Impact Statements

County Procedures

Finance 3.2.c.

In an effort to provide an equal and quality education to each student in Kanawha County the board proposes to consolidate services. This closure and consolidation would save the Board of Education \$387,279.00 annually. Savings on maintenance and operating expenses on aging buildings that they currently do not have the finances to properly maintain.

Personnel 3.2.d.

The County Board of Education has attempted to reduce staff due to a loss in enrollment over the past ten years to meet the formula for professional and service personnel. This closure and consolidation would result in a reduction of 8 Professional Personnel and 6 Service Personnel. Kanawha County will continue to follow the WVDE recommended guidelines on the number of employees but maintain the number of staff required to deliver the education programs made available to its students. Some Staff may be reduced due to the duplication of positions after merger.

Transportation 3.2.e.

There are no negative variances with any of the bus routes from the Green Valley of Saint Albans, Jefferson, or Spring Hill of South Charleston areas. The routes will not exceed the thirty minute guideline as outlined in the WVDE Policy 6200, et al. Detailed information is found on page twenty one of this document.

Educational Program 3.2.f.

Kanawha County Schools ensures an engaging educational environment for learners (students and adults) focusing on teaching and learning in the 21st century. Our mission statement is “to provide a world-class education that ensures success for every student in the 21st century. We Believe: All student CAN achieve. Quality teaching is the key to student success.”

Expectations of parents have evolved through the years, as society has changed. Safe environment, cleanliness, fiscal responsibility, and healthy lifestyles are important issues that are conducive to learning. Parents expect their students to obtain a quality education and to be able to function successfully in life.

3.2.a Enrollment

County Procedures

Enrollment and Population Table

Trends in student population growth or decline in the county for the previous 10 years.

Year	2013-2014	2014-2015	2015-2016	2016-2017	2017-2018	2018-2019	2019-2020	2020-2021	2021-2022	2022-2023
Total	28,076	27,604	27,339	26,335	26,230	25,757	25,387	24,799	24,164	23,714

Enrollment Table 1

Trends in student population growth or decline in the attendance area of the school targeted for closure or consolidation for the previous 10 years.

George C. Weimer Elementary School

Year	2013-2014	2014-2015	2015-2016	2016-2017	2017-2018	2018-2019	2019-2020	2020-2021	2021-2022	2022-2023
Total	172	188	174	176	174	180	142	136	138	138

Enrollment Table 2

Alban Elementary School

Year	2013-2014	2014-2015	2015-2016	2016-2017	2017-2018	2018-2019	2019-2020	2020-2021	2021-2022	2022-2023
Total	376	370	355	352	328	311	305	285	251	255

Enrollment Table 3

Bridgeview Elementary School

Year	2013-2014	2014-2015	2015-2016	2016-2017	2017-2018	2018-2019	2019-2020	2020-2021	2021-2022	2022-2023
Total	486	475	467	474	474	447	427	412	400	422

Enrollment Table 4

Population characteristics, such as birth and death rates and age composition of population for the previous ten years, as provided by the most recent Census data for the county.

County Birth and Death Rates

Year	2010	2011	2012	2013	2014	2015	2016	2017	2018	2019
Birth Rate	N/A	11.2	11.6	11.7	11.4	10.9	10.5	10.5	10.3	9.8
Death Rate	N/A	12.4	12.5	13.0	12.8	13.4	13.5	14.2	14.8	14.1

Sources for data :West Virginia Department of Health & Human Resources Bureau for Public Health Health Statistics Center

Enrollment Table 5

3.2.a Enrollment

County Procedures

County Population Data

Year	Total Population	1 to 9	10 to 19	20 to 29	30 to 39	40 to 49	50 to 59	60 to 69	70 to 79	80 and Over
2010	193,068	12.1%	10.9%	11.6%	12.2%	13.6%	15.8%	11.3%	8.3%	4.2%
2011	192,315	11.3%	11.2%	11.7%	12.9%	12.5%	17.0%	11.5%	7.0%	4.7%
2012	192,179	11.0%	11.7%	11.7%	12.4%	12.9%	15.9%	12.7%	7.2%	4.4%
2013	191,275	10.9%	11.6%	12.0%	12.9%	12.0%	15.9%	13.3%	6.2%	5.2%
2014	190,223	11.6%	10.7%	12.1%	12.1%	12.8%	15.8%	12.6%	8.0%	4.4%
2015	188,332	11.0%	11.2%	11.4%	12.4%	12.7%	14.0%	15.2%	7.4%	4.5%
2016	186,241	11.8%	10.2%	12.0%	11.7%	12.9%	15.3%	13.9%	8.5%	4.0%
2017	183,293	11.8%	10.9%	11.4%	11.8%	12.4%	13.0%	15.4%	8.2%	5.0%
2018	180,454	11.2%	10.4%	11.9%	11.7%	12.3%	14.3%	15.2%	8.2%	4.9%
2019	178,124	10.3%	11.3%	11.9%	11.9%	12.3%	13.5%	13.7%	9.8%	5.2%

Sources for data :West Virginia Department of Health & Human Resources Bureau for Public Health Health Statistics Center & United States Census Bureau

Enrollment Table 6

Projections of enrollment, by grade and school, in the affected attendance area, for the next ten years.

George C. Weimer Elementary School

Year	2023-2024	2024-2025	2025-2026	2026-2027	2027-2028	2028-2029	2029-2030	2030-2031	2031-2032	2032-2033
Pre-K	16	15	13	10	19	21	28	18	18	15
K	27	16	15	13	10	19	21	28	18	18
1st	18	27	16	15	13	10	19	21	28	18
2nd	18	18	27	16	15	13	10	19	21	28
3rd	14	18	18	27	16	15	13	10	19	21
4th	18	14	18	18	27	16	15	13	10	19
5th	22	18	14	18	18	27	16	15	13	10
Total	133	126	121	117	118	121	122	124	127	129

Sources for data :West Virginia Department of Education ZOOMWV

Enrollment Table 7

3.2.a Enrollment

County Procedures

Alban Elementary School

Year	2023-2024	2024-2025	2025-2026	2026-2027	2027-2028	2028-2029	2029-2030	2030-2031	2031-2032	2032-2033
Pre-K	4	29	26	29	32	45	38	8	34	31
K	37	4	29	26	29	32	45	38	8	34
1st	39	37	4	29	26	29	32	45	38	8
2nd	36	39	37	4	29	26	29	32	45	38
3rd	37	36	39	37	4	29	26	29	32	45
4th	24	37	36	39	37	4	29	26	29	32
5th	48	24	37	36	39	37	4	29	26	29
Total	225	206	208	200	196	202	203	207	212	217

Sources for data : West Virginia Department of Education ZOOMWV
Enrollment Table 8

Bridgeview Elementary School

Year	2023-2024	2024-2025	2025-2026	2026-2027	2027-2028	2028-2029	2029-2030	2030-2031	2031-2032	2032-2033
Pre-K	40	49	46	49	55	68	55	46	57	52
K	52	40	49	46	49	55	68	55	46	57
1st	56	52	40	49	46	49	55	68	55	46
2nd	57	56	52	40	49	46	49	55	68	55
3rd	56	57	56	52	40	49	46	49	55	68
4th	65	56	57	56	52	40	49	46	49	55
5th	69	65	56	57	56	52	40	49	46	49
Total	395	375	356	349	347	359	362	368	376	382

Sources for data : West Virginia Department of Education ZOOMWV
Enrollment Table 9

Projection Method

Explanation of the projection method utilized addressing the relationship between the most recent Second Month Report, the Second Month Reports for the previous three years, and the most recent census data for the county.

Kanawha County Schools uses the Cohort Survival Ratio Technique for enrollment projection. The source of the enrollment data for all schools is taken from the second month report that is submitted to the West Virginia Department of Education. Enrollment data is kept in the reporting for the past ten years and it assists on making future projections. Resident live births and computation of survival ratios are factors that are also considered for enrollment projection.

3.2.b. Facilities

County Procedures

Descriptive Maps

Maps showing the school(s) targeted for closure or consolidation and the school(s) that the county designates to receive the students with mileage indicated between and among schools affected. The map shall include a legend indicating the grade configuration, student enrollment, and utilization percentage for each school on the map.

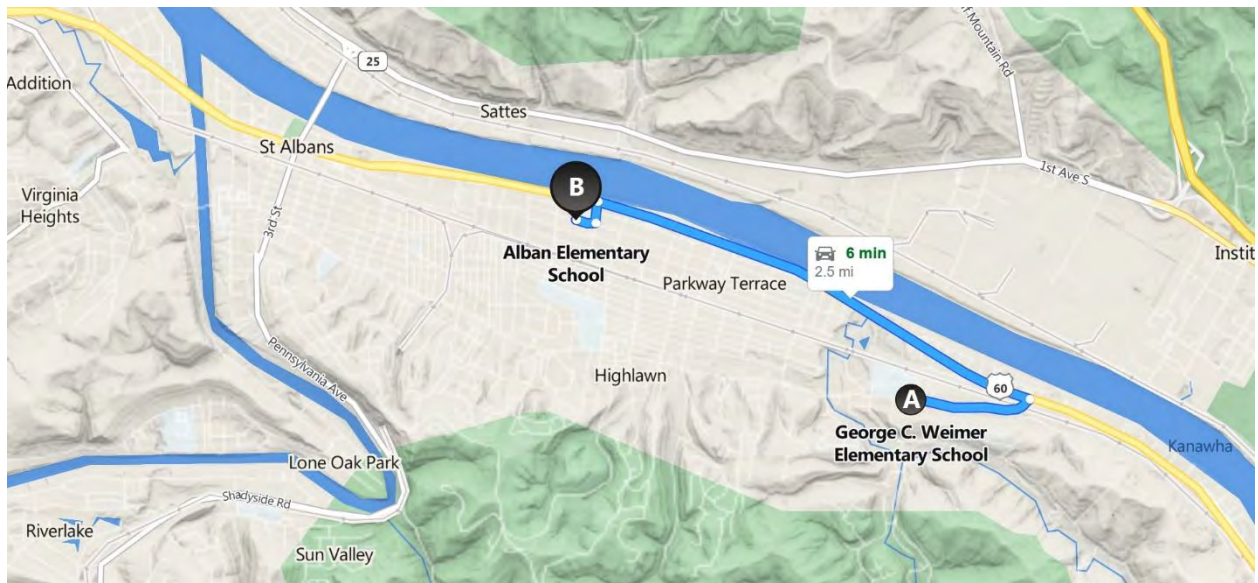

Map 1

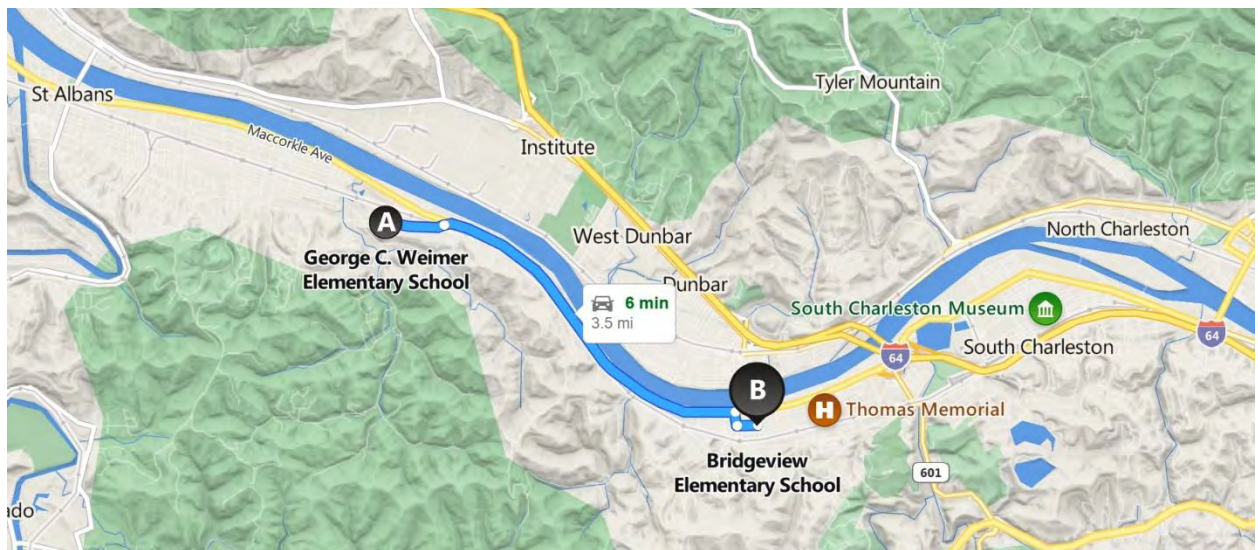

Map 2

3.2.b. Facilities

County Procedures

School	Grade Config.	Current or Anticipated Enrollment	Utilization	Distance to School A	Distance to School B	Distance to School C
George C. Weimer Elementary School (Closing School)	PK-5	138	44.8%	-	2.5 Miles	3.5 Miles
Alban Elementary School (Receiving School)	PK-5	255	56.3%	2.5 Miles	-	-
Bridgeview Elementary School (Receiving School)	PK-5	422	67.0%	3.5 Miles	-	-

Facilities Table 1

3.2.b. Facilities

County Procedures

Written Facility Condition Description

Written description of the physical condition of the school targeted for closure or consolidation and the school or schools which the county designates to receive the students. This description shall include age, number of buildings, general condition, adequacy of structural, electrical, and mechanical systems to provide a safe and healthful environment.

George C. Weimer Elementary School is a 22,221 square foot non sprinkled multi-level masonry building. The original 9,288 square foot section was constructed in 1951. This section of the building contains six of the thirteen classrooms, restrooms, Library, Computer Lab, Counselor's Office, and mechanical room. In 1961 George C. Weimer Elementary School received a 8,602 square foot seven classroom, office suite, and mechanical room addition. In 1969 a 4,331 square foot addition was added. This addition would contain a kitchen, multipurpose room, and custodial office. George C. Weimer currently uses one portable for offices.

The 1951 section of George C. Weimer needs to be made ADA accessible. A new secured entry is needed and office is needed in the front of the building. The current Main Entry is located in the rear of the school, and is not visible from the parking lot or the front of the school. Aesthetically there are many repairs needed. Major window, roof, HVAC, and electrical renovations are needed. The wooden soffits and fascia need to be replaced. The hot water boiler and electrical panels in the mechanical room located in the 1951 section of the building has been on fire in the past. A separate hot water boiler serves the 1961 section. Window units are used for cooling in the majority of the building. The 1969 section of the building utilizes roof top units for heating and cooling.

Alban Elementary School is a 28,753 square foot sprinkled single story masonry building. The original 9,147 square foot section was constructed in 1962. This section of the building contains six of the nineteen classrooms, half of the multipurpose room, kitchen, speech, and counselor's office. In 1969 Alban Elementary School received a 4,217 square foot three classroom and office suite addition. In 2001 a 15,389 square foot addition was added. This addition would contain a ten classrooms, library, computer lab, multipurpose expansion, and kitchen expansion. Alban Elementary currently uses one portable.

Alban Elementary School needs a secured entry. An addition would allow for the removal of the portable. Aesthetic repairs are needed, but overall the school is clean and in good condition. Window, HVAC, and electrical renovations are needed. Approximately 65% of the EPDM roof is at the end of its expected life span. Hot water boilers, and window units are utilized for the HVAC system through out the majority of the building. Roof Top Units are utilized for HVAC in the 2001 additions. Split systems are used for the HVAC system in the cafeteria and gymnasium.

Bridgeview Elementary School is a non-sprinkled 66,845 square foot two story masonry building. The original 52,916 square foot section was constructed in 1953. This section of the building contains the office suite, gymnasium, stage, cafeteria, library, the bulk of the thirty classrooms, and mechanical room in the basement. In 1962 Bridgeview Elementary School received a 11,539 square foot seven classroom, office, and restroom addition. In 1969 a 2,570 square foot addition was added. This addition would contain one classroom, office, and a photography classroom.

3.2.b. Facilities

County Procedures

A secured entry is needed at Bridgeview Elementary School. Aesthetically, repairs are needed, but overall the school is clean and in good condition. Masonry repairs and possible structural repairs are needed in the gymnasium and some of the upstairs classrooms. A window replacement project replaced most of the original windows, however there are still a few original windows that need replaced. Bridgeview Elementary is scheduled for an HVAC and roof replacement with funds from the approved Kanawha County Schools 2024 School Levy. Triad boilers and window units are utilized through out the majority of the building.

Educational Programs and Related Student Services

Evaluation of the school targeted for closure or consolidation and the school or schools that the county designates to receive the students in regard to the school(s) adaptability to the present and proposed educational programs, and the provisions of related student services.

Policy 6200 guidelines were used in the planning and implementation of the closure of George C. Weimer Elementary School. The latest Comprehensive Educational Facilities Plan will be used in planning and developing any facility improvements at Alban Elementary School or Bridgeview Elementary School, the receiving schools.

Alban Elementary School and Bridgeview Elementary School have adequate space for special needs students. Space is available for Pre-kindergarten classrooms, Kindergarten classrooms, Emotional Disturbance classroom, and Intellectual Disability classroom. Instruction will be designed to teach the West Virginia Content Standards and Objectives.

Alban Elementary and Bridgeview Elementary students, teachers, and staff use technology on a daily basis. The school serves as a Pre-k through 5th with one team per grade level. Student support programs are in place along with the appropriate support staff. Wireless internet access is available throughout the school.

School Enrollments, Capacities, and Utilizations

<i>School</i>	<i>Enrollment</i>	<i>Building Capacity</i>	<i>Utilization %</i>
George C. Weimer Elementary School	138	308	44.8%
Alban Elementary School	255	453	56.3%
Alban Elementary School (Consolidated)	269	443	60.7%
Bridgeview Elementary School	422	630	67.0%
Bridgeview Elementary School (Consolidated)	438	630	69.5%

Facilities Table 2

Utilization Calculation Sheet

The supporting School Building Authority of West Virginia’s (SBA) Worksheet on Building Program Utilization.

See Appendix for this Documentation

3.2.b. Facilities

County Procedures

Required Services and Barrier-free Environments

Comparison of the school(s) targeted for closure or consolidation and the school(s) which the county has designated to receive the students in regard to providing the required services and barrier-free environments to students with disabilities.

The original 1951 section of George C. Weimer Elementary School is not ADA accessible. The 1961 addition and the 1969 addition are ADA accessible depending on which entrance is used. To access either the 1961 addition from the 1969 addition or the 1969 addition from the 1961 addition, a disabled person would have to exit the facility and go around the outside of the building. Three ADA accessible restrooms are located in the 1961 addition near the office.

Alban Elementary School maintains ADA accessibility throughout the entirety of the building. Alban has two single occupant ADA accessible restrooms in the building.

Bridgeview Elementary School maintains ADA accessibility throughout the entirety of the building. Bridgeview Elementary School has several ADA accessible single occupant toilets throughout the building.

Grade Configurations and Educational Programs

Elaboration on the effect the proposed school closing or consolidation will have on the school system's future plans regarding grade configuration, educational programs, and facility requirements.

The closure of George C. Weimer Elementary School would allow for more efficient and increased dispersion of resources to areas of need. It would give the students of Kanawha County Schools access to more appropriate and advantageous educational programs.

Construction Work Required for the Proposed Action

Elaboration on the planned facility additions, renovations, or replacements that are required by the county to accommodate the proposed closing and consolidation.

Additions, renovations, or replacements are not required or proposed to George C. Weimer Elementary for closure.

Additions, renovations, or replacements are not required or proposed to Alban Elementary School to accommodate a portion of the George C. Weimer Elementary School enrollment.

Additions, renovations, or replacements are not required or proposed to Bridgeview Elementary School to accommodate a portion of the George C. Weimer Elementary School enrollment.

The Future of Closed Facilities

Elaboration on the future use or disposal of facilities designated by the county for closure.

George C. Weimer Elementary School will be a permanent closure into Alban Elementary School and Bridgeview Elementary School. George C. Weimer Elementary School will be demolished and the site will be reclaimed.

3.2.b. Facilities

County Procedures

School Building Authority of WV (SBA)

Identify if the proposed school closing or consolidation is contingent upon receiving funding from the SBA.

The closure of George C. Weimer School is not contingent upon SBA funding. The current George C. Weimer Elementary school students would be absorbed into Alban Elementary School and Bridgeview Elementary School.

SBA Facility Condition Documentation

Attachment of the most recent SBA facility evaluation form for each school affected and an updated form if the most recent SBA facility evaluation form is five years old or older.

[See Appendix for this Documentation](#)

Supporting Photographs, Floorplans, and other Documentation

Provide facility floorplans, photos, and any supporting documentation. Examples of supporting documentation includes reports from architects, engineers, Fire Marshall, and insurance companies.

[See Appendix for this Documentation](#)

3.2.c. Finance

County Procedures

Itemization of Anticipated Cost and Savings

Itemization of the anticipated cost or savings the county will experience in all areas as a result of the proposed school closure or consolidation. Such itemization shall be in the form of a table indicating the following:

Closing School(s) Annual Current Cost

The current annual cost at the school(s) to be closed for:

George C. Weimer Elementary School

<i>Item</i>	<i>Amount</i>
<i>Utilities</i>	\$41,490.72
<i>Personnel</i>	\$1,094,336.88
<i>Maintenance</i>	\$86,072.00
<i>Transportation</i>	\$35,171.79
<i>Other</i>	\$5,654.80
<i>Total</i>	\$1,262,726.19

Finance Table 1

Receiving School(s) Annual Current Cost (If Applicable)

The current annual cost at the school(s) to be receiving for:

Alban Elementary School

<i>Item</i>	<i>Amount</i>
<i>Utilities</i>	\$55,792.10
<i>Personnel</i>	\$1,599,281.38
<i>Maintenance</i>	\$189,984.40
<i>Transportation</i>	\$62,703.81
<i>Other</i>	\$13,084.85
<i>Total</i>	\$1,920,846.54

Finance Table 2

Bridgeview Elementary School

<i>Item</i>	<i>Amount</i>
<i>Utilities</i>	\$91,732.19
<i>Personnel</i>	\$2,212,419.18
<i>Maintenance</i>	\$41,993.00
<i>Transportation</i>	\$100,937.85
<i>Other</i>	\$17,261.75
<i>Total</i>	\$2,464,343.97 *Figure updated April 11, 2023

Finance Table 3

3.2.c. Finance

County Procedures

Anticipated Annual Cost after Action

The anticipated annual cost at the school(s) to be receiving for:

Alban Elementary School

<i>Item</i>	<i>Amount</i>
<i>Utilities</i>	\$81,152.10
<i>Personnel</i>	\$2,282,982.38
<i>Maintenance</i>	\$196,870.40
<i>Transportation</i>	\$91,761.81
<i>Other</i>	\$19,032.85
<i>Total</i>	\$2,671,799.54

Finance Table 4

Bridgeview Elementary School

<i>Item</i>	<i>Amount</i>
<i>Utilities</i>	\$96,732.19
<i>Personnel</i>	\$2,323,135.81
<i>Maintenance</i>	\$43,714.00
<i>Transportation</i>	\$107,054.85
<i>Other</i>	\$18,202.75
<i>Total</i>	\$2,588,839.60

Finance Table 5

Net Cost or Savings

the net cost or savings of the school(s) to be closed and the school(s) designated by the county to be receiving students for:

George C. Weimer, Alban, and Bridgeview Elementary Schools

<i>Item</i>	<i>Amount</i>
<i>Utilities</i>	\$11,131.00 Savings
<i>Personnel</i>	\$299,920.00 Savings
<i>Maintenance</i>	\$77,465.00 Savings
<i>Transportation</i>	-\$3.00 Cost
<i>Other</i>	-\$1,234.00 Cost
<i>Total</i>	\$387,279.00 Savings

Finance Table 6

3.2.c. Finance

County Procedures

Anticipated Construction Cost to Accommodate Action

Cost of any renovation or addition resulting from the proposed school closure or consolidation, including all proposed funding sources.

George C. Weimer Elementary School

An anticipated demolition and site reclamation project would occur at George C. Weimer Elementary. The demolition and reclamation project would be anticipated at \$200,000.00.

Alban Elementary School

No anticipated construction is needed to accommodate the students from George C. Weimer.

Bridgview Elementary School

No anticipated construction is needed to accommodate the students from George C. Weimer.

County Expense Fund History

Five-year history of the county's unrestricted general current expense fund balance and that balance as a percentage of the county's approved levy estimate.

<i>Year</i>	<i>Unrestricted General Current Expense Fund Balance</i>	<i>Approved Levy Estimate</i>	<i>Percentage of Approved Levy Estimate</i>
2022	\$52,668,539.00	\$230,870,062.00	22.81%
2021	\$41,235,334.00	\$239,881,973.00	17.19%
2020	\$51,430,753.00	\$237,323,995.00	21.67%
2019	\$29,080,399.00	\$226,766,487.00	12.82%
2018	\$35,071,404.00	\$225,541,222.00	15.55%

3.2.d. Personnel

County Procedures

Analysis of Anticipated Personnel Changes

An analysis of the effect the proposed school closure or consolidation will have on professional and service personnel. The analysis shall include, at a minimum, the following data regarding the anticipated increases or decreases in employment as a result of this proposed closure or consolidation:

George C. Weimer Elementary School – Current School Personnel Data Chart				
Professional Personnel	Administration	Teachers	Counselor	Nurse
<i>number professional personnel currently employed at the affected school(s);</i>	1	11	1	0
Service Personnel	Cooks	Aides	Custodians	Secretary
<i>number service personnel currently employed at the affected school(s);</i>	2	3	2	1

Current Personnel

Alban Elementary School – Current Before Proposed Action				
Professional Personnel	Administration	Teachers	Counselor	Nurse
<i>number professional personnel currently employed at the affected school(s);</i>	1	18	1	0
Service Personnel	Cooks	Aides	Custodians	Secretary
<i>number service personnel currently employed at the affected school(s);</i>	3	1	2	1

Current Personnel

Bridgeview Elementary School – Current Before Proposed Action				
Professional Personnel	Administration	Teachers	Counselor	Nurse
<i>number professional personnel currently employed at the affected school(s);</i>	2	25	1	0
Service Personnel	Cooks	Aides	Custodians	Secretary
<i>number service personnel currently employed at the affected school(s);</i>	4.5	8	3.5	1

Current Personnel

Current Affected School Total – Before Proposed Action				
Professional Personnel	Administration	Teachers	Counselor	Nurse
<i>total number of professional personnel currently employed at all affected schools;</i>	4	54	3	0
Service Personnel	Cooks	Aides	Custodians	Secretary
<i>total number of service personnel currently employed at all affected schools;</i>	9.5	12	7.5	3

Current Personnel

3.2.d. Personnel

County Procedures

Alban Elementary School Total – Anticipated After Proposed Action				
Professional Personnel	Administration	Teachers	Counselor	Nurse
<i>total number of professional personnel that are anticipated to be employed at the affected school(s) upon the completion of the closure or consolidation;</i>	1	22	1	0
Service Personnel	Cooks	Aides	Custodians	Secretary
<i>total number of service personnel that are anticipated to be employed at the affected school(s) upon the completion of the closure or consolidation;</i>	3	3	2	1

Anticipated Personnel

Bridgeview Elementary School Total – Anticipated After Proposed Action				
Professional Personnel	Administration	Teachers	Counselor	Nurse
<i>total number of professional personnel that are anticipated to be employed at the affected school(s) upon the completion of the closure or consolidation;</i>	2	26	1	0
Service Personnel	Cooks	Aides	Custodians	Secretary
<i>total number of service personnel that are anticipated to be employed at the affected school(s) upon the completion of the closure or consolidation;</i>	4.5	8	3.5	1

Anticipated Personnel

Identify Affected School – Anticipated Net Change After Proposed Action				
Professional Personnel	Administration	Teachers	Counselor	Nurse
<i>the anticipated net change in professional personnel due to the proposed closure or consolidation</i>	-1	-6	-1	0
Service Personnel	Cooks	Aides	Custodians	Secretary
<i>the anticipated net change in service personnel due to the proposed closure or consolidation</i>	-2	-1	-2	-1

Anticipated Personnel

3.2.d. Personnel

County Procedures

Identify Affected School – Attrition and Reduction in Force Summary - Professional				
Professional Personnel	Administration	Teachers	Counselor	Nurse
<i>decrease that will occur through attrition</i>	0	0	0	0
<i>decrease that will occur through reduction in force</i>	1	6	1	0
Service Personnel	Cooks	Aides	Custodians	Secretary
<i>decrease that will occur through attrition</i>	0	0	0	0
<i>decrease that will occur through reduction in force</i>	2	1	2	1

Anticipated Personnel

3.2.e. Transportation

County Procedures

Analysis of Anticipated Transportation Time Changes

Explain any negative variances of 126CSR172, Policy 6200, Handbook on Planning School Facilities (Policy 6200), section 202.02, and the effects the variances may have on transportation. Provide the following bus route data and travel times:

Current and Difference of Travel Times

List the current travel time by bus route for students in the communities of the schools planned for closure or consolidation and the estimated increase or decrease in travel time as a result of the closure; and

Weimer Elementary School

<i>Route</i>	<i>Community</i>	<i>Current Travel Time</i>	<i>Estimated Time after Closure or Consolidation</i>	<i>Net Increase or Decrease</i>
Route 1708	Jefferson	18 Min	25 Min	7 Min Increase
Route 1907	Green Valley	25 Min	30 Min	5 Min Increase

Transportation Table 1

Alban Elementary School

<i>Route</i>	<i>Community</i>	<i>Current Travel Time</i>	<i>Estimated Time after Closure or Consolidation</i>	<i>Net Increase or Decrease</i>
Route 1909	Spruce Street	11 Min	11 Min	0 Min
Route 2101	Walnut Street	7 Min	7 Min	0 Min
Route 1912	Washington Avenue	5 Min	5 Min	0 Min

Transportation Table 2

Bridgeview Elementary School

<i>Route</i>	<i>Community</i>	<i>Current Travel Time</i>	<i>Estimated Time after Closure or Consolidation</i>	<i>Net Increase or Decrease</i>
Route 1516	Chestnut Street	20 Min	20 Min	0 Min
Route 1603	South Charleston	30 Min	30 Min	0 Min

Transportation Table 3

3.2.e. Transportation

County Procedures

Anticipated Routes and Waiver Requests

List all anticipated bus routes after the proposed closure or consolidation with the estimated total one-way travel time for each route. Clearly identify any bus routes that exceed the recommended travel times and any routes which will require a waiver of W. Va. 126CSR92, Policy 4336, West Virginia School Bus Transportation Regulations, Procedures, and Specifications for the Design and Equipment of School Buses.

Alban Elementary School

Route	Community	One-way Travel Time	Amount Exceeding Recommended Travel Times	Is a Waiver of W. Va. 126CSR92, Policy 4336 Required (Yes / no)
Route 1907	Green Valley	30 Min	0 Min	No
Route 1909	Spruce Street	11 Min	0 Min	No
Route 2101	Walnut Street	7 Min	0 Min	No
Route 1912	Washington Avenue	5 Min	0 Min	No

Transportation Table 4

Bridgeview Elementary School

Route	Community	One-way Travel Time	Amount Exceeding Recommended Travel Times	Is a Waiver of W. Va. 126CSR92, Policy 4336 Required (Yes / no)
Route 1708	Jefferson	25 Min	0 Min	No
Route 1516	Chestnut Street	20 Min	0 Min	No
Route 1603	South Charleston	30 Min	0 Min	No

Transportation Table 5

3.2.f. Educational Program

County Procedures

Analysis and Assurance of Consideration

Complete a projected educational program improvement analysis which includes a statement of assurance that the following have been considered:

Affected School Name(s)

[George C. Weimer Elementary School](#), [Alban Elementary School](#), and [Bridgeview Elementary School](#)

In the preparation of the documents regarding the closure and/or consolidation of the above referenced school, the following codes and policies have been considered:

[Please check each item that was considered.](#)

- W. Va. 126CSR16, Policy 2419, Regulations for the Education of Students with Exceptionalities,*
- W. Va. 126CSR42, Policy 2510, Assuring the Quality of Education: Regulations for Education Programs,*
- W. Va. 126CSR44 et al., Policy 2520, Content Standards and Objectives for West Virginia Schools,*
- WVBE Policy 6200-Planning of School Facilities*
- WVBE Policy 6204-School Closings or Consolidations*

[See Appendix for this documentation](#)

Superintendent

Date:

3.3. & 3.4. Public Notices and Hearings

County Procedures

Notice of Public Hearing(s)

The county must provide notice for the public hearing which shall be advertised through a Class III legal advertisement for three weeks prior to the date of the hearing in a newspaper in general circulation in the locality of any school to be closed or consolidated and in the locality of any school that has been designated by the county to receive students from the schools to be closed or consolidated. The notice also shall be posted in all schools as provided in section 3.3.5 at least 30 days prior to the date of hearing.

If the county will be applying for SBA funding, the procedures must be completed before the SBA will consider a project for funding, as further outlined in section 6. If the county will be utilizing local funding for a construction project related to the closure or consolidation, the procedures must be completed prior to the initiation of construction. For all other closures and consolidations, counties must complete the procedures on or before December 31st of the calendar year prior to the calendar year in which the closures or consolidations are to be effective.

NOTICE OF PUBLIC HEARING

Kanawha County Schools

W.Va. 18-5-13a

W. Va. Board of Education Policy 6204

DATE and TIME: May 4, 2023, at 6:00 p.m.

Sign in between 5:00 and 5:55 p.m. to speak

ALTERNATIVE DATE and TIME: If, in the event of inclement weather or other factors beyond the control of the board, the hearing cannot take place at the date and time set forth above, the hearing will be held on May 11, 2023, at 6:00 p.m.

PLACE: St. Albans High School Auditorium, 2100 Kanawha Terrace, St. Albans, WV 25177. The hearing location is subject to change if, at the time the meeting is called to order, it is determined that the meeting location is of insufficient size to accommodate those wishing to attend.

The hearing may not continue beyond 11:00 p.m. In the event the hearing is not concluded by 11:00 p.m., the hearing may recess, to continue on dates designated and announced by the board just prior to the hearing recess, to be continued day-to-day until concluded.

Proposed Action of the Board of Education of the County of Kanawha, West Virginia:

George C. Weimer Elementary School -Close and transfer of students to Alban Elementary and Bridgeview Elementary.

3.3. & 3.4. Public Notices and Hearings

County Procedures

Hearing Procedures: A representative of Kanawha County Schools will provide an oral summary of the reasons and supporting data in connection with the proposed action of the Board. For a period of fifty-five minutes prior to the commencement of the public hearing, persons may sign a register for the purpose of making statements, offering testimony and questioning school officials. Persons wishing to speak about the effects of the proposed closure of George C. Weimer Elementary and consolidation into Alban Elementary and Bridgeview Elementary, as well as those who wish to speak as members of the general public, will be recognized in the order in which they have signed the register. Each person shall be limited to three/five minutes. Written statements may be submitted in lieu of oral statements or testimony and must be submitted prior to the conclusion of the hearing. Any written statement will be given full consideration before the board takes any final action.

Reasons and supporting data available for public inspection: Written reasons and supporting data in connection with the proposed action of the Board are available for public inspection beginning March, 29, 2023, through May 4, 2023, between the hours of 7:30 a.m. and 4:00 p.m. in the Office of the Superintendent of Kanawha County Schools located in Room 222, 200 Elizabeth Street, Charleston, West Virginia. The reasons and the supporting data in connection with the proposed actions are also available for inspection at George C. Weimer Elementary, Alban Elementary and Bridgeview Elementary.

George C. Weimer Elementary School, Alban Elementary School, and Bridgeview Elementary School

First Run: April 3, 2023

Second Run: April 10, 2023

Third Run: April 17, 2023

Qualified Newspaper Name: Charleston Gazette Mail

3.3. & 3.4. Public Notices and Hearings

County Procedures

Proof of Public Hearing(s) Notice

contain proof that the hearings were properly advertised with a class III legal advertisement. Such proof can be satisfied with:

- *a notarized letter from the county's qualified newspaper(s) for legal notices, as defined by the West Virginia Secretary of State, that specifically states the three dates in which the newspaper ran the county's public hearing notification; or*
- *a scan or download for each of the 3 required legal advertisements from the county's qualified newspaper(s) for legal notices, as defined by the West Virginia Secretary of State, where the full legal notification and date of publication is provided and legible.*

[See Appendix for this Documentation](#)

Public Hearing(s) Documentation

Provide documentation of all hearings, motions, written public comments, a synopsis or transcript of verbal public comments, and other actions concerning the proposed school closings and consolidations.

[See Appendix for this Documentation](#)

3.6. County Board Actions

County Procedures

County Board Vote(s)

After the vote and following compliance with sections 3.4 and 3.5, and prior to the implementation of any school closure or consolidation and following compliance with all statutory and regulatory provisions, the county must file a request for school closure and/or consolidation with the WVBE for approval.

Comprehensive Educational Facilities Plan (CEFP)

Identify if the proposed school closing or consolidation was included in the county's approved CEFP. If the county's approved CEFP did not contain the proposed closure or consolidation, the county must also submit a request to amend their CEFP. Such request shall include all required CEFP amendment forms.

The closure of George C. Weimer Elementary School is not congruent with Kanawha County Schools 2020- 2030 CEFP Plan.

School Building Authority of WV

Identify if the proposed school closing or consolidation is contingent upon receiving funding from the SBA.

The closure of George C. Weimer Elementary School is not contingent upon SBA funding. The current George C. Weimer Elementary school students would be absorbed into Alban Elementary School and Bridgeview Elementary School.

3.6.a. Superintendent Verification of Board Actions

County Procedures

George C. Weimer Elementary School, Alban Elementary School, and Bridgeview Elementary School

Date of hearing: Thursday May 4, 2023 at 6:00 P.M.

Date of board approval: Thursday May 4, 2023 following hearing

Kanawha County requests the West Virginia Board of Education approve the following.

Closure and Consolidation of George C. Weimer Elementary School into Alban Elementary School and Bridgeview Elementary School.

- The county assures that the applicable sections of the W. Va. Codes §18-5-13 and §18-5-13a, and WVBE Policies 6200 and 6204 have been addressed.*
- This action is justified by the provided supplemental data and information pertinent to the following subjects: enrollment, facilities, finance, personnel, transportation, and educational programs.*
- Documentation of all hearings, motions, written public comments, a synopsis or transcript of verbal comments, and other actions concerning the proposed school closings and consolidations were provided in this document.*
- All hearings were properly advertised with a class III legal advertisement.*

Thomas E. Williams, Jr., Ed.D.

Signature of county superintendent attesting to the completion of all requirements as stated in W. Va. Codes §18-5-13 and §18-5-13a and WVBE Policies 6200 and 6204.

[See Appendix for this documentation](#)

Superintendent

Date:

Appendix of Supporting Data

The list should include at a minimum the following data:

- 1. SBA Worksheet on Building Program Utilization for all affected schools (Required)*
- 2. Supporting Photographs, Floorplans, and other Documentation (As needed)*
- 3. SBA Facility Condition Documentation for all affected schools (Required)*
- 4. Proof of Public Hearing(s) Notice for all affected schools (Required)*
- 5. Public Hearing(s) Documentation for all affected schools (Required)*
- 6. Board minutes indicating the action of the board to approve the closure(s) (Required)*
- 7. Cover letter addressed to the State Superintendent of Schools (Required)*
- 8. Completed superintendent signature pages (Required)*
- 9. Most current October 1st certified enrollment for county (Required)*

Appendix of Supporting Data

County Procedures

1. SBA Worksheets on Building Program Utilization

The supporting School Building Authority of West Virginia's (SBA) Worksheets on Building Program Utilization for:

[George C. Weimer Elementary School Utilization Sheet](#)

[Alban Elementary School Utilization Sheet](#)

[Bridgeview Elementary School Utilization Sheet](#)

[Alban Elementary School Utilization Sheet \(Combined\)](#)

[Bridgeview Elementary School Utilization Sheet \(Combined\)](#)

School Building Authority of West Virginia
BUILDING PROGRAM UTILIZATION WORKSHEET
 Worksheet #3
SBA FORM 301-C

NOTE: THIS FORM MAY BE SUBSTITUTED FOR A SIMILAR SBA-APPROVED DIGITAL INSTRUMENT

County: Kanawha County School: George C. Weimer Elementary School Current Enrollment: 138

<i>Classroom Types</i>	<i>Number Of Classroom Types</i>	<i>x</i>	<i>Maximum Pupils/ Class Capacity</i>	<i>=</i>	<i>Total Program Capacity</i>
Pre-K	1		20		20
Kindergarten	1		20		20
General Classrooms	10		25		250
Spec Ed LVL 1	1		6		6
Spec Ed LVL 2	1		12		12
TOTALS:	14				308

Program Utilization ($\frac{138}{\text{Current Enrollment}}$ divided by $\frac{308}{\text{Total Program Capacity}}$) times 100 = 44.8 %
Program Utilization

SCHOOLS PROGRAM UTILIZATION = 44.8 % Desirable Program Capacity = 85%

Instructions for Calculating Building Program Utilization

Elementary School – Calculate the number and type of classrooms using the maximum program capacity for each self-contained regular classroom. Assume for example – that all students are seated in a first period block without pullout programs. Do not include library/media, cafeteria, itinerant spaces, resource rooms, or optional academic classrooms such as art, music and computer labs that act as pullout programs to support the core curriculum.

Secondary School – Middle/Junior High School programs where various schedules exist, calculate the number and type of classrooms using the maximum program capacity for each regular or special classroom. Assume for example, that all students are seated in a first period block and exclude library/media, commons or any space that cannot be used for other course offerings in the daily capacity of each facility. The maximum capacity for instructional spaces for specialty classrooms is counted once. A specialty classroom may be available throughout the school day but due to its specialized design or equipment it is rendered impractical to use for other instructional purposes.

SBA 301-C

School Building Authority of West Virginia
BUILDING PROGRAM UTILIZATION WORKSHEET
 Worksheet #3
SBA FORM 301-C

NOTE: THIS FORM MAY BE SUBSTITUTED FOR A SIMILAR SBA-APPROVED DIGITAL INSTRUMENT

County: Kanawha County School: Alban Elementary School Current Enrollment: 255

<i>Classroom Types</i>	<i>Number Of Classroom Types</i>	<i>x</i>	<i>Maximum Pupils/ Class Capacity</i>	<i>=</i>	<i>Total Program Capacity</i>
Pre-K	1		20		20
Kindergarten	2		20		40
General Classrooms	15		25		375
Spec Ed LVL 1	1		6		6
Spec Ed Level 2	1		12		12
TOTALS:	20				453

Program Utilization ($\frac{255}{\text{Current Enrollment}}$ divided by $\frac{453}{\text{Total Program Capacity}}$) times 100 = 56.3 %
 Program Utilization

SCHOOLS PROGRAM UTILIZATION = 56.3 % Desirable Program Capacity = 85%

Instructions for Calculating Building Program Utilization

Elementary School – Calculate the number and type of classrooms using the maximum program capacity for each self-contained regular classroom. Assume for example – that all students are seated in a first period block without pullout programs. Do not include library/media, cafeteria, itinerant spaces, resource rooms, or optional academic classrooms such as art, music and computer labs that act as pullout programs to support the core curriculum.

Secondary School – Middle/Junior High School programs where various schedules exist, calculate the number and type of classrooms using the maximum program capacity for each regular or special classroom. Assume for example, that all students are seated in a first period block and exclude library/media, commons or any space that cannot be used for other course offerings in the daily capacity of each facility. The maximum capacity for instructional spaces for specialty classrooms is counted once. A specialty classroom may be available throughout the school day but due to its specialized design or equipment it is rendered impractical to use for other instructional purposes.

SBA 301-C

School Building Authority of West Virginia
BUILDING PROGRAM UTILIZATION WORKSHEET
 Worksheet #3
SBA FORM 301-C

NOTE: THIS FORM MAY BE SUBSTITUTED FOR A SIMILAR SBA-APPROVED DIGITAL INSTRUMENT

County: Kanawha County School: Bridgeview Elementary School Current Enrollment: 422

<i>Classroom Types</i>	<i>Number Of Classroom Types</i>	<i>x</i>	<i>Maximum Pupils/ Class Capacity</i>	<i>=</i>	<i>Total Program Capacity</i>
Pre-K	2		20		40
Kindergarten	3		20		60
General Classrooms	20		25		500
Spec Ed LVL 1	3		6		18
Spec Ed Level 2	1		12		12
TOTALS:	29				630

Program Utilization ($\frac{422}{\text{Current Enrollment}}$ divided by $\frac{630}{\text{Total Program Capacity}}$) times 100 = $\frac{67.0}{\text{Program Utilization}}$ %

SCHOOLS PROGRAM UTILIZATION = 67.0 % Desirable Program Capacity = 85%

Instructions for Calculating Building Program Utilization

Elementary School – Calculate the number and type of classrooms using the maximum program capacity for each self-contained regular classroom. Assume for example – that all students are seated in a first period block without pullout programs. Do not include library/media, cafeteria, itinerant spaces, resource rooms, or optional academic classrooms such as art, music and computer labs that act as pullout programs to support the core curriculum.

Secondary School – Middle/Junior High School programs where various schedules exist, calculate the number and type of classrooms using the maximum program capacity for each regular or special classroom. Assume for example, that all students are seated in a first period block and exclude library/media, commons or any space that cannot be used for other course offerings in the daily capacity of each facility. The maximum capacity for instructional spaces for specialty classrooms is counted once. A specialty classroom may be available throughout the school day but due to its specialized design or equipment it is rendered impractical to use for other instructional purposes.

SBA 301-C

School Building Authority of West Virginia
BUILDING PROGRAM UTILIZATION WORKSHEET
 Worksheet #3
SBA FORM 301-C

NOTE: THIS FORM MAY BE SUBSTITUTED FOR A SIMILAR SBA-APPROVED DIGITAL INSTRUMENT

County: Kanawha County School: Alban Elementary School Receiving Enrollment: 269

<i>Classroom Types</i>	<i>Number Of Classroom Types</i>	<i>x</i>	<i>Maximum Pupils/ Class Capacity</i>	<i>=</i>	<i>Total Program Capacity</i>
Pre-K	2		20		40
Kindergarten	3		20		60
General Classrooms	13		25		325
Spec Ed LVL 1	1		6		6
Spec Ed Level 2	1		12		12
TOTALS:	20				443

Program Utilization (269 divided by 443) times 100 = 60.7 %
 Current Enrollment Total Program Capacity Program Utilization

SCHOOLS PROGRAM UTILIZATION = 60.7 % Desirable Program Capacity = 85%

Instructions for Calculating Building Program Utilization

Elementary School – Calculate the number and type of classrooms using the maximum program capacity for each self-contained regular classroom. Assume for example – that all students are seated in a first period block without pullout programs. Do not include library/media, cafeteria, itinerant spaces, resource rooms, or optional academic classrooms such as art, music and computer labs that act as pullout programs to support the core curriculum.

Secondary School – Middle/Junior High School programs where various schedules exist, calculate the number and type of classrooms using the maximum program capacity for each regular or special classroom. Assume for example, that all students are seated in a first period block and exclude library/media, commons or any space that cannot be used for other course offerings in the daily capacity of each facility. The maximum capacity for instructional spaces for specialty classrooms is counted once. A specialty classroom may be available throughout the school day but due to its specialized design or equipment it is rendered impractical to use for other instructional purposes.

SBA 301-C

School Building Authority of West Virginia
BUILDING PROGRAM UTILIZATION WORKSHEET
 Worksheet #3
SBA FORM 301-C

NOTE: THIS FORM MAY BE SUBSTITUTED FOR A SIMILAR SBA-APPROVED DIGITAL INSTRUMENT

County: Kanawha County School: Bridgeview Elementary School Receiving Enrollment: 438

<i>Classroom Types</i>	<i>Number Of Classroom Types</i>	<i>x</i>	<i>Maximum Pupils/ Class Capacity</i>	<i>=</i>	<i>Total Program Capacity</i>
Pre-K	2		20		40
Kindergarten	3		20		60
General Classrooms	20		25		350
Spec Ed LVL 1	3		6		18
Spec Ed Level 2	1		12		12
TOTALS:	29				630

Program Utilization ($\frac{438}{\text{Current Enrollment}}$ divided by $\frac{630}{\text{Total Program Capacity}}$) times 100 = $\frac{69.5}{\text{Program Utilization}}$ %

SCHOOLS PROGRAM UTILIZATION = 69.5 % Desirable Program Capacity = 85%

Instructions for Calculating Building Program Utilization

Elementary School – Calculate the number and type of classrooms using the maximum program capacity for each self-contained regular classroom. Assume for example – that all students are seated in a first period block without pullout programs. Do not include library/media, cafeteria, itinerant spaces, resource rooms, or optional academic classrooms such as art, music and computer labs that act as pullout programs to support the core curriculum.

Secondary School – Middle/Junior High School programs where various schedules exist, calculate the number and type of classrooms using the maximum program capacity for each regular or special classroom. Assume for example, that all students are seated in a first period block and exclude library/media, commons or any space that cannot be used for other course offerings in the daily capacity of each facility. The maximum capacity for instructional spaces for specialty classrooms is counted once. A specialty classroom may be available throughout the school day but due to its specialized design or equipment it is rendered impractical to use for other instructional purposes.

SBA 301-C

Appendix of Supporting Data

County Procedures

2. Supporting Photographs, Floorplans, and other Documentation

[George C. Weimer Elementary School](#)



























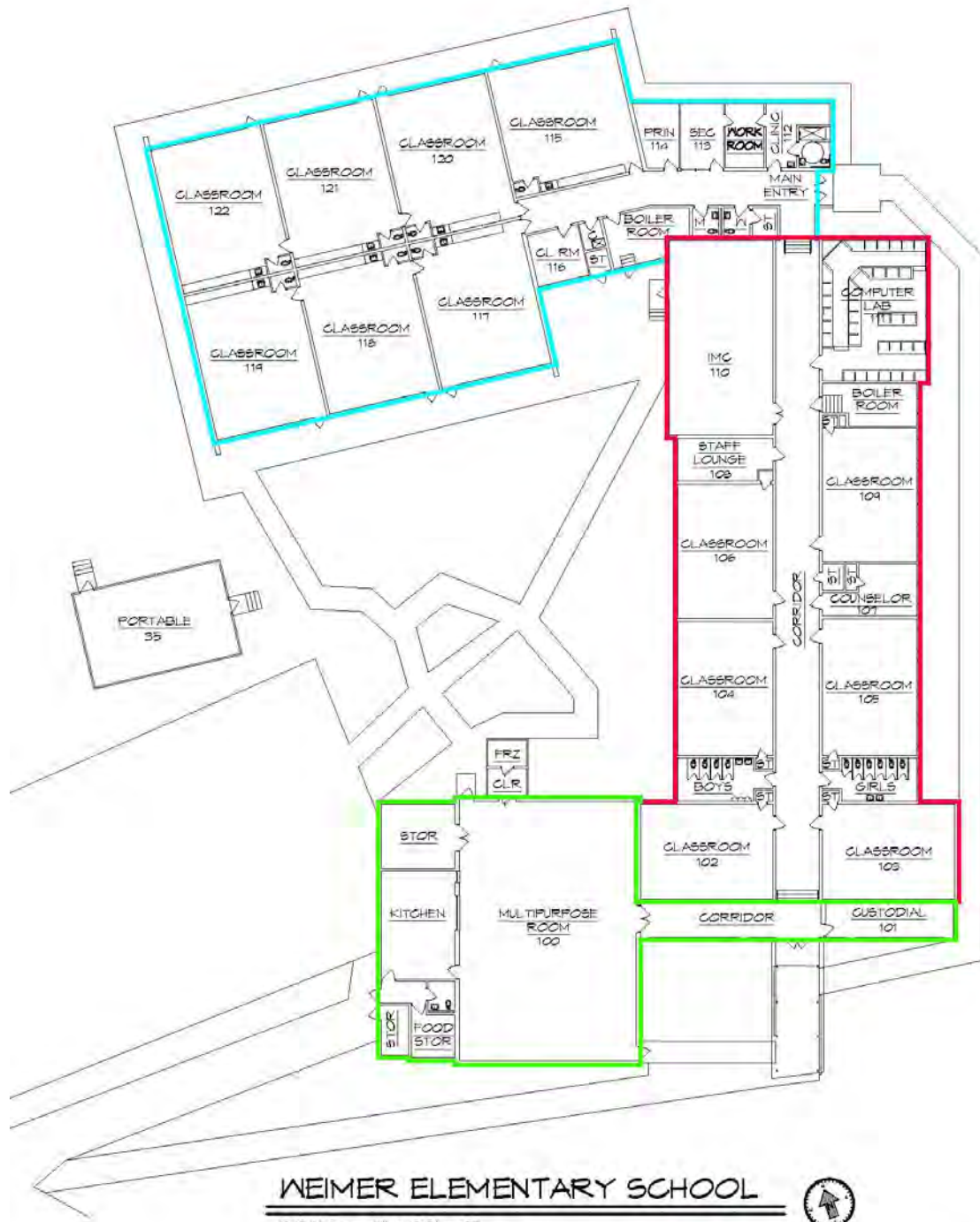

█	1951 ORIGINAL CONSTRUCTION	9,288 SQ. FT.
█	1961 ADDITION	8,602 SQ. FT.
█	1969 ADDITION	4,331 SQ. FT.
	TOTAL SCHOOL	22,221 SQ. FT.

MARCH 1, 2023

Alban Elementary School





















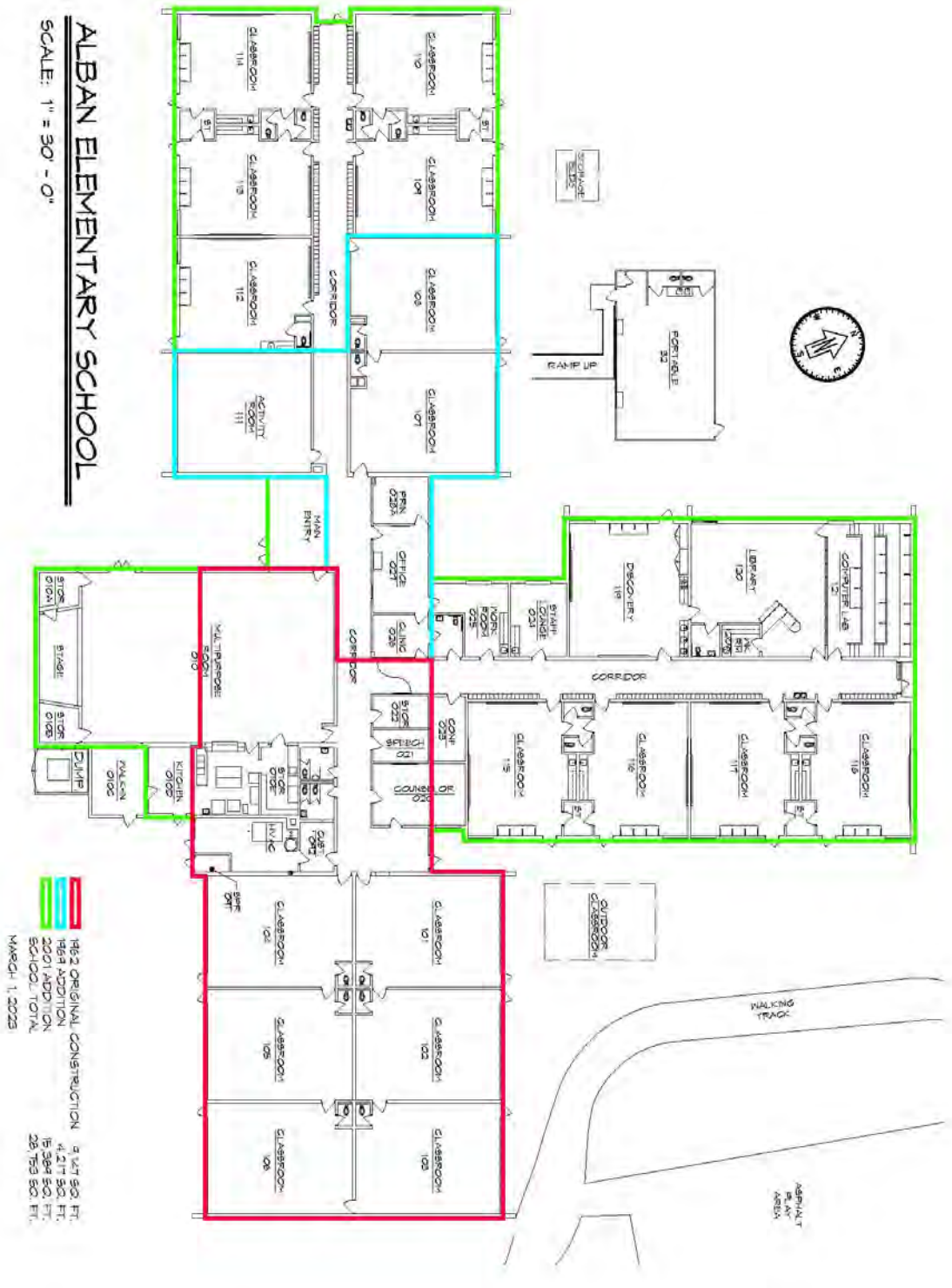

Bridgeview Elementary School

















BRIDGEVIEW ELEMENTARY SCHOOL

SCALE: 1" = 40' - 0"



█ 1953 ORIGINAL CONSTRUCTION 52,916 SQ. FT.
█ 1962 ADDITION 11,294 SQ. FT.
█ 1969 ADDITION 2,570 SQ. FT.
 SCHOOL TOTAL 66,845 SQ. FT.

FEBRUARY 28, 2025

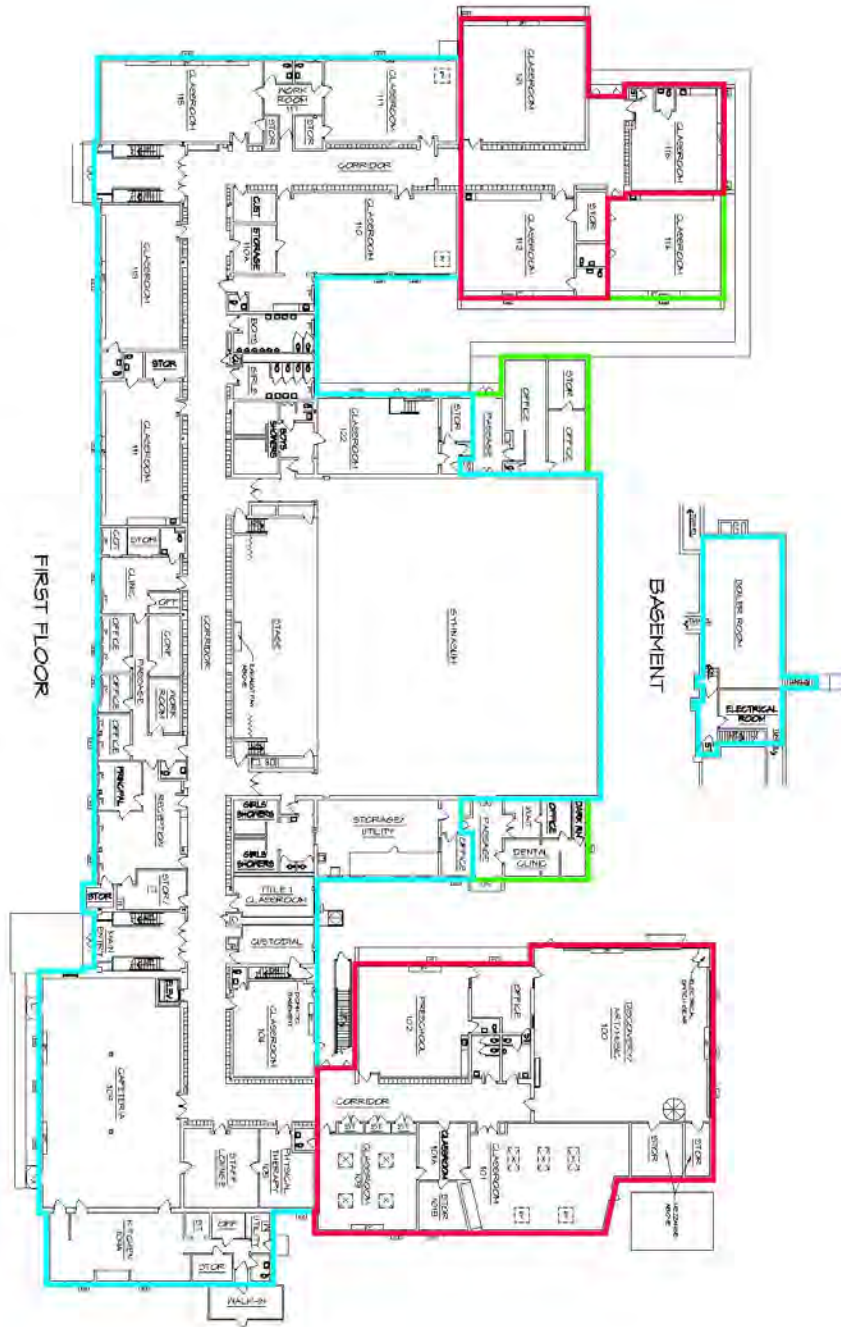

BRIDGEVIEW ELEMENTARY SCHOOL

SCALE: 1" = 40' - 0"



1963 ORIGINAL CONSTRUCTION
 1962 ADDITION
 1964 ADDITION
 SCHOOL TOTAL

FEBRUARY 28, 2025

52,916 SQ. FT.
 11,294 SQ. FT.
 2,570 SQ. FT.
 66,845 SQ. FT.

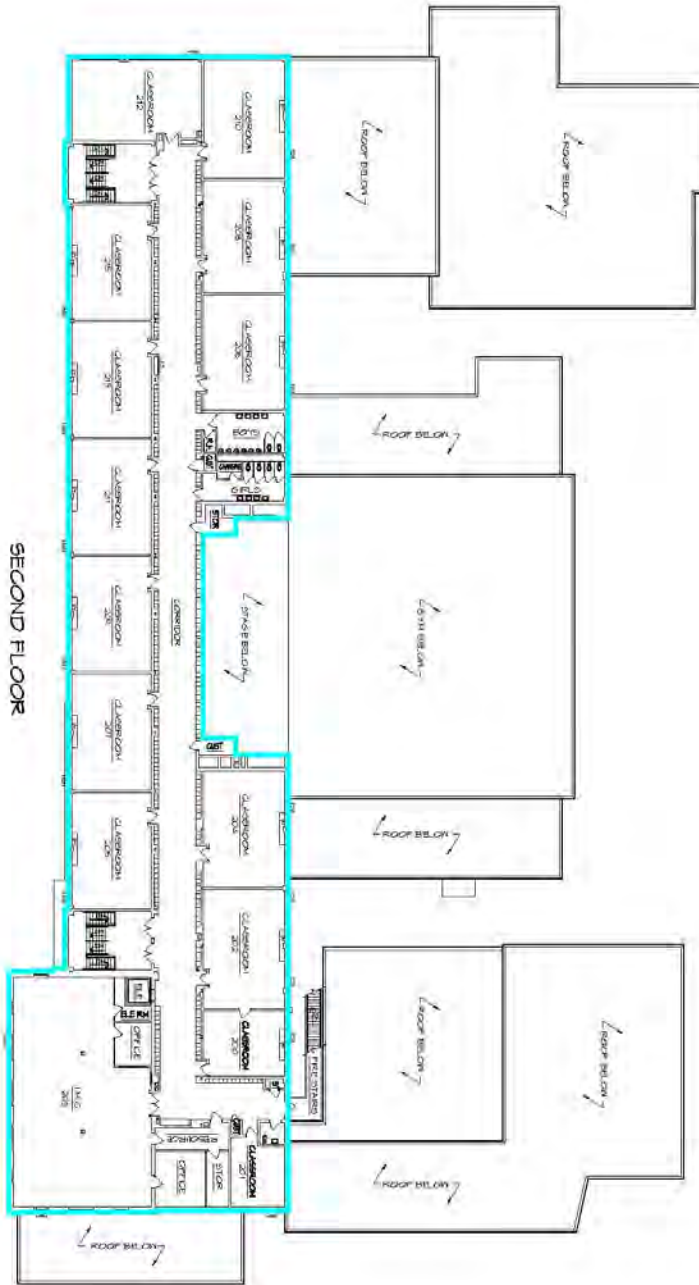

Appendix of Supporting Data

County Procedures

3. SBA Facility Condition Documentation

The supporting School Building Authority of West Virginia's (SBA) Facility Evaluation Form for:

George C. Weimer Elementary School Facility Evaluation Form

Alban Elementary School Facility Evaluation Form

Bridgeview Elementary School Facility Evaluation Form

School Building Authority of West Virginia
SBA Form 134 Data Collection Form
Building Information Sheet

Building Cross Square Feet	Main Building	New Built Basement 22,213 (N/N)	1951	# Floors (incl. Bas.)	1
			N		

System	Material	Count	Condition	Notes	Year Installed if different from Building
Conveying Systems			Not Present		
Electrical - Branch Wiring			2 - Below Average 3 - Average	39 of 79 systems have been evaluated. Most of the wiring is 50 years old.	
Electrical - Lighting	Fluorescent		1 - Average		
Electrical - Emergency Lighting and Exit Signs			2 - Below Average	The MOP is a retrofit of 400 A 208/120 V 3 phase panel into an existing endbay. Adjacent panel cabinets were damaged by a boiler fire (date unknown).	
Electrical - Service and Distribution	Includes Commercial		3 - Average		
Equipment & Furnishings - Institutional Equipment	Metals		3 - Average	Door and frame out of multipurpose room is sagging away and will need replaced.	
Exterior Enddoors - Exterior Doors	Metals		3 - Average		
Exterior Enddoors - Exterior Wall Finishes	Masonry		3 - Average		
Exterior Enddoors - Exterior Windows	Single Pane, Fixed, All Glass Types		2 - Below Average		
Fire Protection - Fire Alarm & Detection			1 - Average	Fire Alarm Control Panel (1) Simplex 2001 (1981) - 54 events 15-250	
Fire Protection - Sprinklers and Standpipes			Not Present		
HVAC - Terminal & Package Units			Not Present	See Overview for details. The school has several mechanical rooms. One room is in the gymnasium. One room is in the cafeteria. One room is in the main building. One room is in the boiler room. One room is in the 1951 building. Original boiler has no tag and experienced fire or flame rollout about unknown date. 1951 Addition - Atmospheric boiler with 1450 mbh. Input with no GCR tag.	
HVAC - Distribution System			2 - Below Average		
HVAC - Hot Generating Systems			2 - Below Average		
HVAC - Cooling Generating Systems			Not Present		
HVAC - Controls and Instrumentation			1 - Inadequate	Prognosis: When Unit Users overheat, Teachers open access doors and empty 13V fans.	
Interior Construction - Interior Doors	Solid Core Wood		3 - Average		
Interior Construction - Scaffolds and Casework			3 - Average		
Interior Finishes - Ceiling Finishes	Acoustic		3 - Average	Textile decking in the armory ceiling. Some areas are ACT and some are 1204 panels. The original building has VCT installed over wood floors. Some classrooms still have exposed wood floors.	
Interior Finishes - Floor Finishes	Vinyl Composite Tile		3 - Average		
Interior Finishes - Gymnasium Floor Finishes			3 - Average	The gym is the multipurpose room with VCT flooring.	
Interior Finishes - Wall Finishes	Painted CMU		3 - Average	There are a couple of cracks present in the high walls of the multipurpose room.	
Plumbing - Domestic Water Distribution			3 - Average		
Plumbing - Fixtures	Metals		2 - Below Average	Older plumbing fixtures, floor types (metal) have exposed branch piping.	
Plumbing - Rain Water Drainage			3 - Average		
Plumbing - Sanitary Sewer			3 - Average		
Roofing - Roof Coverings	Modified Bitumen		2 - Below Average	Roof was not fully assessable, but portion viewed will need replaced in less than 10 years.	
Security System			3 - Average		
Technology Infrastructure			3 - Average		

School Building Authority of West Virginia
 SBA Form 134 Data Collection Form
 Facility General Information Sheet

1 - Facility General Information Worksheet

LEA ID:	039276	Assessment Date:	10/14/19
County:	Kanawha	Total Gross Square Feet:	22,213
Facility Name:	George C. Weimer Elementary School	Original Year of Construction:	1951

Energy Indexes

(List the total amount of each fuel source used for one year)

Source (Units)	Consumption per Year	Conversion (BTU/Unit)	Total BTU
Electric (Kilowatt-Hrs)	258,240	3,412	881,151,034
Natural Gas (MCF) --OR--	1,526	1,037,000	1,582,150,900
Natural Gas (Decotherms)		1,000,000	-
Coal (Tons)		24,000,000	-
#2 Fuel Oil (Gallons)		138,874	-
Propane (Pounds)		21,600	-
Used Oil (Gallons)		125,000	-
Wood Chips (Tons)		16,500,000	-
Other (specify)			-
Amount:			
Units:			

Total BTU: 2,463,301,934
 Energy Utilization Index (EUI): 110,895

Worksheet Links:

School Building Authority of West Virginia
 SBA Form 134 Data Collection Form
 Site Evaluation Sheet

LEA ID:	039276	Assessment Date:	10/14/19
County:	Kanawha	Total Gross Square Feet:	22,213
Facility Name:	George C. Weimer Elementary S	Original Year of Construction:	1951

2 - Site Evaluation Worksheet

Site

City or Rural:	City
Actual Acres:	4.25
Useable Acres:	4
Site adequate for expansion:	Yes
Are public parks/areas adjacent:	No
% site out of flood plain:	100%
% site in flood plain:	0%
Site Remarks:	Edge of site is shared with McKinley Middle School
Overall Site Condition:	2-Below Average

Drainage

Drainage Remarks:	
Overall Drainage Condition:	3-Average

Parking

Parking Adequately Lit:	No
Adequacy of Parking:	2-Below Average
Parking Remarks:	
Overall Parking Condition:	2-Below Average

Bus Loading

Bus Loading Adequate:	No
Bus Loading Remarks:	
Overall Bus loading Condition:	2-Below Average

Access Roads

Adequacy of On-Site Access Roads:	2-Below Average
Adequacy of Off-Site Access Roads:	3-Average

Access Roads Remarks: [Redacted]

Overall Access Road Condition: 3-Average

Playfields/Playcourts

Adequacy of Playfields: 3-Average

Adequacy of Playcourts: 3-Average

Playfields/Playcourts Remarks: [Redacted]

Overall Playfield/Playcourts Condition: 3-Average

Site Utilities

Electrical Services:

Phase: 3

Voltage: 208/120

Amps: 400

Electric Utility Company: AEP

Main Service Feed into Building: Overhead

Electrical Service Remarks: [Redacted]

Overall Electrical Service Condition: 3-Average

Fuel Sources:

Natural Gas: Yes

Coal: [Redacted]

Fuel Oils: [Redacted]

Propane: [Redacted]

Other (Specify): [Redacted]

Fuel Line Size (inches): 3"

Fuel Utility Company: Mountaineer Gas

Fuel Sources Remarks: [Redacted]

Overall Fuel Sources Condition: 3-Average

Water Sources:

Public: Yes

Well: [Redacted]

Water Line Size (inches): 2-1/2" reduced to 2"

Water Utility Company: St. Albans

Water Sources Remarks: [Redacted]

Overall Water Sources Condition: 3-Average

Sewage Systems:

Public:

Yes

Septic:

Other (Specify):

Public Service District (PSD):

St. Albans

Sewage System Remarks:

Overall Sewage System Condition:

3-Average

School Building Authority of West Virginia
 SBA Form 134 Data Collection Form
 Building Component Evaluation Sheet

LEA ID:	039276	Assessment Date:	10/14/19
County:	Kanawha	Total Gross Square Feet:	22,213
Facility Name:	George C. Weimer Elementary S	Original Year of Construction:	1951

3 - Building Component Evaluation Worksheet

Building Structures:

Type:

Building Structures Remarks:

Overall Building Structure Condition:

Floor Structures:

Steel Joist/Concrete (floor area SF):

Wood Joists (floor area SF):

Slab on Grade (floor area SF):

Other (specify) / Floor area SF:

Floor Structure Remarks:

Overall Floor Structure Condition:

Roof:

Roof Structure:

Roof Structures Remarks:

Overall Roof Condition:

Building Systems:

The systems below are addressed in the FCA data collection tool.

- Roof Coverings
- Wall Finishes
- Ceiling Finishes
- Floor Finishes
- Doors
- Windows
- HVAC
- Electrical
- Fire Alarm



Technology Infrastructure:

Sufficient Electrical Capacity:

Power Receptacles Availability:

ID Network Type (if available):	Yes	3-Average
Inventory Records Hardware	Yes	4-Above Average
Other (specify):		
Deficiencies:		
Technology Remarks:		
Overall Technology Infrastructure Condition:	3-Average	

Technology Assessment:

Teacher Training:	4-Above Average
Software Use:	4-Above Average
Purchasing Practices:	4-Above Average
Network Administration:	4-Above Average
Inventory Records	4-Above Average
Other (specify):	
Deficiencies:	
Technology Remarks:	
Overall Technology Condition:	4-Above Average

School Access Safety Audit:

Planning:	
Deterrence:	
Detection:	
Delay:	
Communication:	
Evacuation:	
Safety Remarks:	
Overall Access Safety Condition:	

School Building Authority of West Virginia
 SBA Form 134 Data Collection Form
 Facility Spaces Evaluation / Utilization Analysis Sheet

LEA ID: 039276 Assessment Date: 4/37/52
 County: Kanawha Total Gross Square Feet: 22213
 Facility Name: George C. Weimer Elementary School Original Year of Construction: 1951

Classroom Type	Grade Config		Age of Facility	No. of Renovations	Square Ft	Portables	Location (City, St)	Utilization Calculation
	PK - 5	5						
Pre-Kindergarten (Full Day)	2		69		22,213	0	St. Albans, WV	Current Enrollment 179
Kindergarten (Full Day)	1							Total Program Capacity 272
General Purpose Classroom	8							Utilization Calculation 66%
Computer Lab	n/a							Desirable Utilization 85%
Art Lab	n/a							Difference -19%
Music Classroom	n/a							
Special Ed Pull-out	n/a							
Special Ed Level 1: (PK-5)	1							
Special Ed Level 1: (6-12)	n/a							
Special Ed Level 2: (PK-12)	0							
Special Ed Level 3: (PK-12)	0							
Special Education Classroom	1							
Technical Education/ Voc Ag	n/a							
Physical Education	n/a							
Science Classroom/Lab	n/a							
Business Education	n/a							
Family Liv/Cons Economics	n/a							
Totals	13	0	0	0	272	0	272	

School Building Authority of West Virginia
SBA Form 134 Data Collection Form
School Improvement Cost Summary Sheet

LEA ID:	039276	Assessment Date:	10/14/19
County:	Kanawha	Total Gross Square Feet:	22213
Facility Name:	George C. Weimer Elementary School	Original Year of Construction:	1951
Design Capacity Enrollment:	272		

Please note, the current-year costs shown below are intended to provide a Rough Order of Magnitude (ROM) estimate of costs. While they are appropriate for high-level capital forecasting, they should not be relied upon for determining specific project funding values. Actual project costs will likely deviate from the presented values due to a variety of factors including, but not limited to, hard and soft cost fluctuations and the actual date of construction for the intended project. Therefore, detailed cost estimates are recommended to validate funding requirements prior to obligating funds for facility replacement or renovation.

Improvement Item

1. Site Work

Improvement Item	Unit	Quantity	Unit Cost	Item Cost	Remarks
Land Acquisition	Acres			\$ -	
Excavation/Grade	CUB FT			\$ -	
Drainage	LIN FT			\$ -	
Walks (6 ft wide)	SQ FT			\$ -	
Parking	SQ FT			\$ -	
Bus Loading	SQ FT			\$ -	
Roads	SQ FT			\$ -	
Playing Fields	SQ FT			\$ -	
Other (Describe in 'Remarks')				\$ -	
Other (Describe in 'Remarks')				\$ -	
Other (Describe in 'Remarks')				\$ -	
Sub-Total				\$ -	

2. Renovations, Exterior

Improvement Item	Unit	Quantity	Unit Cost	Item Cost	Remarks
Wall Structure	SQ FT			\$ -	
Floor Structure	SQ FT			\$ -	
Roof Structure	SQ FT			\$ -	
Wall Facing	SQ FT			\$ -	
Windows	EACH			\$ -	
Doors/Frames	EACH			\$ -	
Roofing	SQ FT	22,213	\$ 20.00	\$ 444,260.00	
Coping/Parapet	LIN FT			\$ -	
Painting	SQ FT			\$ -	
Other (Describe in 'Remarks')				\$ -	
Other (Describe in 'Remarks')				\$ -	
Other (Describe in 'Remarks')				\$ -	
Sub-Total				\$ 444,260.00	

3. Renovations, Interior

Improvement Item	Unit	Quantity	Unit Cost	Item Cost	Remarks
Floor Covering	SQ FT			\$ -	
Patch & Painting	SQ FT			\$ -	
Ceiling Finish	SQ FT			\$ -	
Plumbing	SQ FT			\$ -	
Heating/Ventilating	SQ FT	22,213	\$ 40.00	\$ 888,520.00	
Air Conditioning	SQ FT			\$ -	
Lighting	SQ FT			\$ -	
Wiring	SQ FT	22,213	\$ 7.00	\$ 155,491.00	
Fire Alarm	SQ FT			\$ -	
Communication System	SQ FT			\$ -	
Technology				\$ -	
Interior Doors	EACH			\$ -	
Other (Describe in 'Remarks')				\$ -	
Other (Describe in 'Remarks')				\$ -	
Other (Describe in 'Remarks')				\$ -	
Sub-Total				\$ 1,044,011.00	

4. Building Additions Including Furniture, Furnishings & Equipment

Improvement Item	Unit	Quantity	Unit Cost	Item Cost	Remarks
Administration (ES, MS, HS)	SQ FT			\$ -	
Student Services (ES, MS, HS)	SQ FT			\$ -	

Kindergarten (ES)	SQ FT			\$ -	
Primary (ES)	SQ FT			\$ -	
Media Center (ES)	SQ FT			\$ -	
Basic (MS, HS)	SQ FT			\$ -	
Reading (MS, HS)	SQ FT			\$ -	
Health Education (MS, HS)	SQ FT			\$ -	
Computer Lab (ES, MS, HS)	SQ FT			\$ -	
Inst. Mat. Center (MS, HS)	SQ FT			\$ -	
Home Economics (MS, HS)	SQ FT			\$ -	
Art (ES, MS, HS)	SQ FT			\$ -	
Ind. Technology (MS, HS)	SQ FT			\$ -	
Music (ES, MS, HS)	SQ FT			\$ -	
Physical Education (MS, HS)	SQ FT			\$ -	
Auditorium (MS, HS)	SQ FT			\$ -	
Special Education (ES, MS, HS)	SQ FT			\$ -	
Multi-Purpose (ES)	SQ FT			\$ -	
Kitchen (ES, MS, HS)	SQ FT			\$ -	
Dining (MS, HS)	SQ FT			\$ -	
Business Education (MS)	SQ FT			\$ -	
Co-Op Education (MS)	SQ FT			\$ -	
Drivers Education (MS)	SQ FT			\$ -	
Staff/Faculty (ES, MS, HS)	SQ FT			\$ -	
Toilets/Fixtures (ES, MS, HS)	SQ FT			\$ -	
Storage General (ES, MS, HS)	SQ FT			\$ -	
Storage Instructional (ES, MS, HS)	SQ FT			\$ -	
Custodial (ES, MS, HS)	SQ FT			\$ -	
Mechanical (MS, HS)	SQ FT			\$ -	
Other (Describe in 'Remarks')	SQ FT	750	\$ 307.00	\$ 230,250.00	SAFE SCHOOL ENTRANCE
Other (Describe in 'Remarks')				\$ -	
Other (Describe in 'Remarks')				\$ -	
Subtotal of Building Additions (SQ FT)		750			
Circulation	30%	225	\$ 307.00	\$ 69,075.00	
Sub-Total				\$ 299,325.00	

	Unit	Quantity	Unit Cost	Item Cost	Remarks
Elevator	EACH			\$ -	
Sprinkler Systems	SQ FT	22,213	\$ 7.00	\$ 155,491.00	
Kitchen Equipment	ALL			\$ -	
Waste Treatment	EACH			\$ -	
Other (Describe in 'Remarks')				\$ -	
Other (Describe in 'Remarks')				\$ -	
Other (Describe in 'Remarks')				\$ -	
Sub-Total				\$ 155,491.00	

	Quantity	Unit Cost	Item Cost	Remarks
			\$ -	
			\$ -	
			\$ -	
Sub-Total			\$ -	
Sub-Total of Items 1 through 6			\$ 1,943,087.00	

	%	Quantity	Item Cost	Remarks
New Construction			\$ -	
Renovations	7.0%	\$1,943,087.00	\$ 136,016.09	
Sub-Total			\$ 136,016.09	

	Unit	Quantity	Unit Cost	Item Cost	Remarks
Survey	EACH			\$ -	
Soil Inv.	EACH			\$ -	
Other (Describe in 'Remarks')				\$ -	
Other (Describe in 'Remarks')				\$ -	
Other (Describe in 'Remarks')				\$ -	
Sub-Total				\$ -	

	%	Quantity	Item Cost	Remarks
New Construction			\$ -	

Renovations	6.0%	\$1,943,087.00	\$ 116,585.22	
Sub-Total			\$ 116,585.22	
Grand Total Project Cost			\$ 2,195,688.31	

Worksheet Links:

[Campus Information](#)

[Building 1](#)

[Building 2](#)

[Building 3](#)

[Building 4](#)

Reference Data from Prior Sheets (for WVDE Use Only):	
Energy Utilization Index:	110,895
Current Enrollment:	179
Program Capacity:	272
Utilization Calculation:	66%
Building(s) in Floodplain/Floodway:	0

School Building Authority of West Virginia
 188 E. Boone 13th State Capitol Annex
 Charleston, West Virginia 25305

Full All Items Name
 Project Name
 Project Number
 Project Type
 School Code

Original Construction Yr.
 Current Construction Yr.



Species	Material	Year Installed	Condition	SP	Notes	Message
Asphalt	Asphalt	1982	Good	100%		
Concrete	Concrete	1982	Good	100%		
Paint	Paint	1982	Good	100%		
Roofing	Roofing	1982	Good	100%		
Windows	Windows	1982	Good	100%		
Doors	Doors	1982	Good	100%		
Plumbing	Plumbing	1982	Good	100%		
Electrical	Electrical	1982	Good	100%		
HVAC	HVAC	1982	Good	100%		
Other	Other	1982	Good	100%		
Total GIP					24,562	

Project Building Name	Year Installed	GIP	Message
1. Main Building	1982	24,562	
2.			
3.			
4.			
5.			
6.			
7.			
8.			
9.			
Total GIP		24,562	

Project Building Name	Year Installed	GIP	Message
1. Main Building	1982	24,562	
2.			
3.			
4.			
5.			
6.			
7.			
8.			
9.			
Total GIP		24,562	

Overview of Findings

The 2022 Building and 2022 Infrastructure Inspection Report, which includes findings from the 2022 Building and 2022 Infrastructure Inspection, is available on the School Building Authority of West Virginia website. The report provides a detailed overview of the findings from the 2022 Building and 2022 Infrastructure Inspection, including a list of findings, a description of each finding, and the recommended actions to address each finding. The report also includes a summary of the findings and a list of recommendations for the School Building Authority of West Virginia. The report is available on the School Building Authority of West Virginia website at <https://www.sba.wv.gov/>.

School Building Authority of West Virginia
SEA Form 134 Data Collection Form
Building Information Sheet

Building Gross Square Feet	Main Building	1962	# Floors (incl. Bsm)	1
	Basement	N		
	28,962 (T/N)	N		

System	Material	Count	Year Installed / date removed from Building	Condition	Notes
Conveying Systems				Not Present	
Electrical - Branch Wiring				3 - Average	The majority of wiring is 50 years old
Electrical - Lighting	Fluorescent			3 - Average	
Electrical - Emergency Lighting and Exit Signs				3 - Average	
Electrical - Service and Distribution				3 - Average	1770 A, 208/120 V/3 phase
Equipment & Furnishings - Institutional Equipment	Commercial Metal			3 - Average	
Exterior Enclosure - Exterior Doors	Masonry			3 - Average	
Exterior Enclosure - Exterior Wall Finishes	Single Pane, Insul. all frame types			2 - Below Average	
Exterior Enclosure - Exterior Windows				2 - Below Average	Fire Alarm Control Panel is Notifier AFP400, vny cdf.
Fire Protection - Fire Alarm & Detection				2 - Below Average	4" service, see Overview for details. Fire Department Connection has only a single hose hook-up.
Fire Protection - Sprinklers and Standpipes				Not Present	See Diagrams for details.
HVAC - Terminal & Package Units				2 - Below Average	1962/1967 Building has 50+ year old low supply unit terminals in classrooms, P.W.
HVAC - Distribution System				3 - Average	2 Forced Draft 500 mah input boilers (2017)
HVAC - Heat Generating Systems				Not Present	
HVAC - Cooling Generalist Systems				2 - Below Average	Pneumatic and DDC.
HVAC - Controls and Instrumentation				3 - Average	
Interior Construction - Interior Doors	Solid One-Wood			3 - Average	
Interior Construction - Specities and Casework				3 - Average	
Interior Finishes - Ceiling Finishes	Exposed			3 - Average	Exposed ceiling in room drooping
Interior Finishes - Floor Finishes	Tile			3 - Average	
Interior Finishes - Gypsum Floor Finishes	Painted GVL			3 - Average	Multi-purpose room flooring is VCT
Interior Finishes - Wall Finishes				3 - Average	
Plumbing - Domestic Water Distribution	Iron/steel			3 - Average	
Plumbing - Rain Water Drainage				3 - Average	
Plumbing - Fixtures				3 - Average	
Plumbing - Sanitary Sewer				3 - Average	
Roofing - Roof Coverings	Membrane			3 - Average	No roof access, so limited viewing of roof. There is a multi-in roof leak throughout the school. Some just dripping in the classroom areas.
Security System				3 - Average	
Technology Infrastructure				3 - Average	

School Building Authority of West Virginia
 SBA Form 134 Data Collection Form
 Facility General Information Sheet

1 - Facility General Information Worksheet

LEA ID:	039201	Assessment Date:	10/14/19
County:	Kanawha	Total Gross Square Feet:	28,962
Facility Name:	Alban Elementary School	Original Year of Construction:	1962

Energy Indexes

(List the total amount of each fuel source used for one year)

Source (Units)	Consumption per Year	Conversion (BTU/Unit)	Total BTU
Electric (Kilowatt-Hrs)	395,680	3,412	1,350,115,555
Natural Gas (MCF) --OR--	775	1,037,000	803,675,000
Natural Gas (Decoثرms)		1,000,000	-
Coal (Tons)		24,000,000	-
#2 Fuel Oil (Gallons)		138,874	-
Propane (Pounds)		21,600	-
Used Oil (Gallons)		125,000	-
Wood Chips (Tons)		16,500,000	-
Other (specify)			-
Amount:			
Units:			

Total BTU: 2,153,790,555
 Energy Utilization Index (EUI): 74,366

Worksheet Links:

School Building Authority of West Virginia
 SBA Form 134 Data Collection Form
 Site Evaluation Sheet

LEA ID:	039201	Assessment Date:	10/14/19
County:	Kanawha	Total Gross Square Feet:	28,962
Facility Name:	Alban Elementary School	Original Year of Construction:	1962

2 - Site Evaluation Worksheet

Site

City or Rural:	City
Actual Acres:	3.04
Useable Acres:	3.04
Site adequate for expansion:	No
Are public parks/areas adjacent:	No
% site out of flood plain:	100%
% site in flood plain:	0%

Site Remarks:	
Overall Site Condition:	3-Average

Drainage

Drainage Remarks:	Street sometimes floods causing access issues
Overall Drainage Condition:	3-Average

Parking

Parking Adequately Lit:	No
Adequacy of Parking:	2-Below Average

Parking Remarks:	
Overall Parking Condition:	2-Below Average

Bus Loading

Bus Loading Adequate:	No
-----------------------	----

Bus Loading Remarks:	Uses street to load and unload buses
Overall Bus loading Condition:	2-Below Average

Access Roads

Adequacy of On-Site Access Roads:	2-Below Average
Adequacy of Off-Site Access Roads:	3-Average

Access Roads Remarks: [Redacted]

Overall Access Road Condition: 3-Average

Playfields/Playcourts

Adequacy of Playfields: 3-Average

Adequacy of Playcourts: 3-Average

Playfields/Playcourts Remarks: [Redacted]

Overall Playfield/Playcourts Condition: 3-Average

Site Utilities

Electrical Services:

Phase: 3

Voltage: 208/120

Amps: 1200

Electric Utility Company: AEP

Main Service Feed into Building: Overhead

Electrical Service Remarks: [Redacted]

Overall Electrical Service Condition: 3-Average

Fuel Sources:

Natural Gas: Yes

Coal: [Redacted]

Fuel Oils: [Redacted]

Propane: [Redacted]

Other (Specify): [Redacted]

Fuel Line Size (inches): 3"

Fuel Utility Company: Mountaineer Gas

Fuel Sources Remarks: [Redacted]

Overall Fuel Sources Condition: 3-Average

Water Sources:

Public: Yes

Well: [Redacted]

Water Line Size (inches): 2"

Water Utility Company: St Albans

Water Sources Remarks: [Redacted]

Overall Water Sources Condition: 3-Average

Sewage Systems:

Public:

Yes

Septic:

Other (Specify):

Public Service District (PSD):

St Albans

Sewage System Remarks:

Overall Sewage System Condition:

3-Average

School Building Authority of West Virginia
 SBA Form 134 Data Collection Form
 Building Component Evaluation Sheet

LEA ID:	039201	Assessment Date:	10/14/19
County:	Kanawha	Total Gross Square Feet:	28,962
Facility Name:	Alban Elementary School	Original Year of Construction:	1962

3 - Building Component Evaluation Worksheet

Building Structures:

Type:

Load Bearing Masonry	
----------------------	--

Building Structures Remarks:

--

Overall Building Structure Condition:

3-Average

Floor Structures:

Steel Joist/Concrete (floor area SF):

--

Wood Joists (floor area SF):

--

Slab on Grade (floor area SF):

28,962

Other (specify) / Floor area SF:

--

Floor Structure Remarks:

--

Overall Floor Structure Condition:

3-Average

Roof:

Roof Structure:

Steel Joists	
--------------	--

Roof Structures Remarks:

--

Overall Roof Condition:

3-Average

Building Systems:

The systems below are addressed in the FCA data collection tool.

Roof Coverings	
Wall Finishes	
Ceiling Finishes	
Floor Finishes	
Doors	
Windows	
HVAC	
Electrical	
Fire Alarm	

Technology Infrastructure:

Sufficient Electrical Capacity:

Yes	3-Average
-----	-----------

Power Receptacles Availability:

Yes	3-Average
-----	-----------

ID Network Type (if available):	Yes	3-Average
Inventory Records Hardware	Yes	4-Above Average
Other (specify):		
Deficiencies:		
Technology Remarks:		
Overall Technology Infrastructure Cond	3-Average	

Technology Assessment:

Teacher Training:	4-Above Average
Software Use:	4-Above Average
Purchasing Practices:	4-Above Average
Network Administration:	4-Above Average
Inventory Records	4-Above Average
Other (specify):	
Deficiencies:	
Technology Remarks:	
Overall Technology Condition:	4-Above Average

School Access Safety Audit:

Planning:	
Deterrence:	
Detection:	
Delay:	
Communication:	
Evacuation:	
Safety Remarks:	
Overall Access Safety Condition:	

School Building Authority of West Virginia
 SBA Form 134 Data Collection Form
 Facility Spaces Evaluation / Utilization Analysis Sheet

LEA ID:	039201	Assessment Date:	4/3/15
County:	Kanawha	Total Gross Square Feet:	28,962
Facility Name:	Albani Elementary School	Original Year of Construction:	1962

Grade Config	PK - 5	Square Ft	28,962	Portables	1	Location (City, St)	St. Albans, WV
Lowest Grade Level:	PK						
Highest Grade Level:	5						

Complete ONLY the column below associated with the highest grade level for this school.

Classroom Type	Number of Class Types		Max Students Per Room	Total Program Capacity	Utilization Calculation
	(MS)	(HS)			
Pre-Kindergarten (Full Day)			20	0	Current Enrollment: 311
Kindergarten (Full Day)	3		20	60	
General Purpose Classroom	16		25	400	
Computer Lab	n/a		25	0	
Art Lab	n/a		25	0	
Music Classroom	n/a		25	0	
Special Ed Pull-out	n/a	n/a	0	0	
Special Ed Level 1: (PK-5)	0		6	0	
Special Ed Level 1: (6-12)	n/a		12	0	
Special Ed Level 2: (PK-12)	0		12	0	
Special Ed Level 3: (PK-12)	0		8	0	
Special Education Classroom	1		6	6	Utilization Calculation: 67%
Technical Education/ Voc Ag	n/a		20	0	
Physical Education	n/a		50	0	
Science Classroom/Lab	n/a		25	0	Desirable Utilization: 85%
Business Education	n/a		25	0	
Family Liv/Con's Economics	n/a		25	0	
Totals	20	0		466	Difference: -18%

School Building Authority of West Virginia
SBA Form 134 Data Collection Form
School Improvement Cost Summary Sheet

LEA ID:	039201	Assessment Date:	10/14/19
County:	Kanawha	Total Gross Square Feet:	28962
Facility Name:	Alban Elementary School	Original Year of Construction:	1962
Design Capacity Enrollment:	466		

Please note, the current-year costs shown below are intended to provide a Rough Order of Magnitude (ROM) estimate of costs. While they are appropriate for high-level capital forecasting, they should not be relied upon for determining specific project funding values. Actual project costs will likely deviate from the presented values due to a variety of factors including, but not limited to, hard and soft cost fluctuations and the actual date of construction for the intended project. Therefore, detailed cost estimates are recommended to validate funding requirements prior to obligating funds for facility replacement or renovation.

Improvement Item	Unit	Quantity	Unit Cost	Item Cost	Remarks
1. Site Work					
Land Acquisition	Acres			\$ -	
Excavation/Grade	CUB FT			\$ -	
Drainage	LIN FT			\$ -	
Walks (6 ft wide)	SQ FT			\$ -	
Parking	SQ FT			\$ -	
Bus Loading	SQ FT			\$ -	
Roads	SQ FT			\$ -	
Playing Fields	SQ FT			\$ -	
Other (Describe in 'Remarks')				\$ -	
Other (Describe in 'Remarks')				\$ -	
Other (Describe in 'Remarks')				\$ -	
Sub-Total				\$ -	

Improvement Item	Unit	Quantity	Unit Cost	Item Cost	Remarks
2. Renovations, Exterior					
Wall Structure	SQ FT			\$ -	
Floor Structure	SQ FT			\$ -	
Roof Structure	SQ FT			\$ -	
Wall Facing	SQ FT			\$ -	
Windows	EACH			\$ -	
Doors/Frames	EACH			\$ -	
Roofing	SQ FT			\$ -	
Coping/Parapet	LIN FT			\$ -	
Painting	SQ FT			\$ -	
Other (Describe in 'Remarks')				\$ -	
Other (Describe in 'Remarks')				\$ -	
Other (Describe in 'Remarks')				\$ -	
Sub-Total				\$ -	

Improvement Item	Unit	Quantity	Unit Cost	Item Cost	Remarks
3. Renovations, Interior					
Floor Covering	SQ FT			\$ -	
Patch & Painting	SQ FT			\$ -	
Ceiling Finish	SQ FT			\$ -	
Plumbing	SQ FT			\$ -	
Heating/Ventilating	SQ FT	28,962	\$ 40.00	\$ 1,158,480.00	
Air Conditioning	SQ FT			\$ -	
Lighting	SQ FT			\$ -	
Wiring	SQ FT			\$ -	
Fire Alarm	SQ FT	28,962	\$ 5.00	\$ 144,810.00	
Communication System	SQ FT			\$ -	
Technology	SQ FT			\$ -	
Interior Doors	EACH			\$ -	
Other (Describe in 'Remarks')	SQ FT	28,962	\$ 7.00	\$ 202,734.00	CONTROLS
Other (Describe in 'Remarks')				\$ -	
Other (Describe in 'Remarks')				\$ -	
Sub-Total				\$ 1,506,024.00	

Improvement Item	Unit	Quantity	Unit Cost	Item Cost	Remarks
4. Building Additions Including Furniture, Furnishings & Equipment					
Administration (ES, MS, HS)	SQ FT			\$ -	
Student Services (ES, MS, HS)	SQ FT			\$ -	

Kindergarten (ES)	SQ FT			\$ -	
Primary (ES)	SQ FT			\$ -	
Media Center (ES)	SQ FT			\$ -	
Basic (MS, HS)	SQ FT			\$ -	
Reading (MS, HS)	SQ FT			\$ -	
Health Education (MS, HS)	SQ FT			\$ -	
Computer Lab (ES, MS, HS)	SQ FT			\$ -	
Inst. Mat. Center (MS, HS)	SQ FT			\$ -	
Home Economics (MS, HS)	SQ FT			\$ -	
Art (ES, MS, HS)	SQ FT			\$ -	
Ind. Technology (MS, HS)	SQ FT			\$ -	
Music (ES, MS, HS)	SQ FT			\$ -	
Physical Education (MS, HS)	SQ FT			\$ -	
Auditorium (MS, HS)	SQ FT			\$ -	
Special Education (ES, MS, HS)	SQ FT			\$ -	
Multi-Purpose (ES)	SQ FT			\$ -	
Kitchen (ES, MS, HS)	SQ FT			\$ -	
Dining (MS, HS)	SQ FT			\$ -	
Business Education (MS)	SQ FT			\$ -	
Co-Op Education (MS)	SQ FT			\$ -	
Drivers Education (MS)	SQ FT			\$ -	
Staff/Faculty (ES, MS, HS)	SQ FT			\$ -	
Toilets/Fixtures (ES, MS, HS)	SQ FT			\$ -	
Storage General (ES, MS, HS)	SQ FT			\$ -	
Storage Instructional (ES, MS, HS)	SQ FT			\$ -	
Custodial (ES, MS, HS)	SQ FT			\$ -	
Mechanical (MS, HS)	SQ FT			\$ -	
Other (Describe in 'Remarks')	SQ FT	750	\$ 307.00	\$ 230,250.00	SAFE SCHOOL ENTRANCE
Other (Describe in 'Remarks')				\$ -	
Other (Describe in 'Remarks')				\$ -	
Subtotal of Building Additions (SQ FT)		750			
Circulation	30%	225	\$ 307.00	\$ 69,075.00	
Sub-Total				\$ 299,325.00	

5. Special Construction	Unit	Quantity	Unit Cost	Item Cost	Remarks
Elevator	EACH			\$ -	
Sprinkler Systems	SQ FT			\$ -	
Kitchen Equipment	ALL			\$ -	
Waste Treatment	EACH			\$ -	
Other (Describe in 'Remarks')				\$ -	
Other (Describe in 'Remarks')				\$ -	
Other (Describe in 'Remarks')				\$ -	
Sub-Total				\$ -	

6. Other Special Costs	Quantity	Unit Cost	Item Cost	Remarks
			\$ -	
			\$ -	
			\$ -	
Sub-Total			\$ -	
Sub-Total of Items 1 through 6			\$ 1,805,349.00	

7. Architectural/Engineering Fees	%	Quantity	Item Cost	Remarks
New Construction			\$ -	
Renovations	7.0%	\$1,805,349.00	\$ 126,374.43	
Sub-Total			\$ 126,374.43	

8. Miscellaneous	Unit	Quantity	Unit Cost	Item Cost	Remarks
Survey	EACH			\$ -	
Soil Inv.	EACH			\$ -	
Other (Describe in 'Remarks')				\$ -	
Other (Describe in 'Remarks')				\$ -	
Other (Describe in 'Remarks')				\$ -	
Sub-Total				\$ -	

9. Contingencies	%	Quantity	Item Cost	Remarks
New Construction			\$ -	

Renovations	6.0%	\$1,805,349.00	\$ 108,320.94
Sub-Total			\$ 108,320.94

Grand Total Project Cost	\$ 2,040,044.37		
---------------------------------	------------------------	--	--

Worksheet Links:

- [Campus Information](#)
- [Building 1](#)
- [Building 2](#)
- [Building 3](#)
- [Building 4](#)
- [Building 5](#)

Reference Data from Prior Sheets (for WVDE Use Only):

Energy Utilization Index:	74,366
Current Enrollment:	311
Program Capacity:	466
Utilization Calculation:	67%
Building(s) in Floodplain/Floodway:	0

School Building Authority of West Virginia
 1000 Kanawha Blvd. SE
 Charleston, West Virginia 25304

Local Public Name
 George C. Weimer
 Campus Name
 George C. Weimer
 School Code
 0000000000

Original Construction Year
 1972
 Current Construction Year
 1972



System	Material	Year Installed from Building	Condition	SR	Notes	Message
1. Main Building		1972	Good	64,642	7	2
2.						
3.						
4.						
5.						
6.						
7.						
8.						
9.						
10.						
11.						
12.						
Total of GFI				64,642		

Material Building Name	Year Installed	Condition	SR	Notes	Message
1.					
2.					
3.					
4.					
5.					
6.					
7.					
8.					
9.					
10.					
11.					
12.					
Total of GFI					

Material Building Name	Year Installed	Condition	SR	Notes	Message
1.					
2.					
3.					
4.					
5.					
6.					
7.					
8.					
9.					
10.					
11.					
12.					
Total of GFI					

School Building Authority of West Virginia
SBA Form 334 Data Collection Form
Building Information Sheet

Building Census Square Code	Main Building	Year Built Reinforced Concrete	1973	# of Floors (Total Stories)	3
	64,642		N		3

System	Material	Count	Year Installed if Not Installed from Building	Condition	Notes
Electrical - Emergency Lighting and Exit Signs	Emergency Lighting			3 - Average	2018 all 220 systems have been evaluated
Electrical - Branch Wiring	Electrical (3) Steps			3 - Average	220 re-terminated past end of life. Surfer report re-terminated in classroom.
Electrical - Lighting	Fluorescent			1 - Adequate	No known devices installed. High pressure sodium on exterior. T12 tubes in office areas without timers or controls. Control fixtures on ceiling. Ceiling
Electrical - Emergency Lighting and Exit Signs	Emergency Lighting			1 - Adequate	Insufficient emergency lighting in corridors, cafeteria, and exterior. Exit signs without battery backup (no emergency power). Exit signs too small for current code. Exit signs past end of life. Wall packs past end of life. Wall packs not illuminating properly. Wall packs too high to test. Wall packs damaged.
Electrical - Emergency Lighting and Exit Signs	Emergency Lighting			1 - Adequate	Multi-bay area over 10 years old. Panels over 10 years old. Unloadable panels in student area. Computer room has load shedding. No capacity for expansion.
Electrical - Service and Distribution	Electrical (3) Steps			3 - Average	
Equipment & Hardware - Institutional Equipment	Equipment			3 - Average	
Exterior Finishes - Exterior Doors	Wood			3 - Average	
Exterior Finishes - Exterior Wall Finishes	Masonry			3 - Average	
Exterior Finishes - Exterior Windows	Single-pane, fixed, aluminum			2 - Below Average	
Fire Protection - Fire Alarm & Detection	Fire Protection			2 - Below Average	FAPI's in hallway with battery charger. MC cable for cabling damaged. Test based on manufacturer's instructions.
Fire Protection - Sprinklers and Standpipes	Fire Protection			Not Present	
HVAC - Terminal & Package Units	HVAC			Not Present	Window type AC unit no mechanical ventilation.
HVAC - Distribution System	HVAC			3 - Average	
HVAC - Heat Generating Systems	HVAC			3 - Average	
HVAC - Cooling Generating Systems	HVAC			Not Present	
HVAC - Controls and Instrumentation	HVAC			2 - Above Average	Hydraulic control compression test. No. and no. ask for manual air pressure.
Interior Construction - Interior Floors	Solid Core Wood			3 - Average	
Interior Construction - Specialties and Casework	Interior Construction			2 - Below Average	
Interior Finishes - Ceiling Finishes	Interior Finishes			3 - Average	
Interior Finishes - Floor Finishes	Interior Finishes			3 - Average	There are some areas where aggregate concrete floor covers existing. Spalls in classrooms (see Appendix 2).
Interior Finishes - Gypsum Board Finishes	Interior Finishes			3 - Average	
Interior Finishes - Wall Finishes	Interior Finishes			3 - Average	Gym walls have some staining.
Plumbing - Domestic Water Distribution	Plumbing			3 - Average	
Plumbing - Fixtures	Plumbing			3 - Average	
Plumbing - Rain Water Drainage	Plumbing			3 - Average	
Plumbing - Sanitary Sewer	Plumbing			3 - Average	
Roofing - Roof Covering	Roofing			3 - Average	Gymnasium additions are well-maintained and are being done (Appendix 2).
Security System	Security System			2 - Above Average	Power in main safety control room. Equipment in mechanical room. Surfer report on building infrastructure.

School Building Authority of West Virginia
 SBA Form 134 Data Collection Form
 Facility General Information Sheet

1 - Facility General Information Worksheet

LEA ID:	039280	Assessment Date:	10/21/19
County:	Kanawha	Total Gross Square Feet:	64,642
Facility Name:	Bridgeview Elementary School	Original Year of Construction:	1953

Energy Indexes

(List the total amount of each fuel source used for one year)

Source (Units)	Consumption per Year	Conversion (BTU/Unit)	Total BTU
Electric (Kilowatt-Hrs)	558,000	3,412	1,903,974,120
Natural Gas (MCF) --OR--	3,557	1,037,000	3,688,609,000
Natural Gas (Decoثرms)		1,000,000	-
Coal (Tons)		24,000,000	-
#2 Fuel Oil (Gallons)		138,874	-
Propane (Pounds)		21,600	-
Used Oil (Gallons)		125,000	-
Wood Chips (Tons)		16,500,000	-
Other (specify)			-
Amount:			
Units:			

Total BTU: 5,592,583,120
 Energy Utilization Index (EUI): 86,516

Worksheet Links:

School Building Authority of West Virginia
 SBA Form 134 Data Collection Form
 Site Evaluation Sheet

LEA ID:	039280	Assessment Date:	10/21/19
County:	Kanawha	Total Gross Square Feet:	64,642
Facility Name:	Bridgeview Elementary School	Original Year of Construction:	1953

2 - Site Evaluation Worksheet

Site

City or Rural:	City
Actual Acres:	2.3312
Useable Acres:	1.9
Site adequate for expansion:	No
Are public parks/areas adjacent:	No
% site out of flood plain:	83%
% site in flood plain:	17%

Site Remarks:	
Overall Site Condition:	2-Below Average

Drainage

Drainage Remarks:	
Overall Drainage Condition:	3-Average

Parking

Parking Adequately Lit:	No
Adequacy of Parking:	2-Below Average
Parking Remarks:	City is looking at sharing cost for additional lighting at rear of building where the majority of parking is located.
Overall Parking Condition:	2-Below Average

Bus Loading

Bus Loading Adequate:	No
Bus Loading Remarks:	loading is on city streets
Overall Bus loading Condition:	2-Below Average

Access Roads

Adequacy of On-Site Access Roads:	2-Below Average
Adequacy of Off-Site Access Roads:	3-Average

Access Roads Remarks: [Redacted]

Overall Access Road Condition: 3-Average

Playfields/Playcourts

Adequacy of Playfields: 2-Below Average

Adequacy of Playcourts: 3-Average

Playfields/Playcourts Remarks: [Redacted]

Overall Playfield/Playcourts Condition: 2-Below Average

Site Utilities

Electrical Services:

Phase: 3

Voltage: 120/208

Amps: 1200

Electric Utility Company: Appalachian Electric

Main Service Feed into Building: Underground

Electrical Service Remarks: Underground service entrance cannot be evaluated

Overall Electrical Service Condition: 3-Average

Fuel Sources:

Natural Gas: Yes

Coal: [Redacted]

Fuel Oils: [Redacted]

Propane: No

Other (Specify): [Redacted]

Fuel Line Size (inches): 6

Fuel Utility Company: Mountaineer Gas

Fuel Sources Remarks: [Redacted]

Overall Fuel Sources Condition: 3-Average

Water Sources:

Public: Yes

Well: [Redacted]

Water Line Size (inches): 3

Water Utility Company: West Virginia American Water

Water Sources Remarks: [Redacted]

Overall Water Sources Condition: 3-Average

Sewage Systems:

Public:

Yes

Septic:

Other (Specify):

Public Service District (PSD):

South Charleston Municipal

Sewage System Remarks:

Overall Sewage System Condition:

3-Average

School Building Authority of West Virginia
 SBA Form 134 Data Collection Form
 Building Component Evaluation Sheet

LEA ID:	039280	Assessment Date:	10/21/19
County:	Kanawha	Total Gross Square Feet:	64,642
Facility Name:	Bridgeview Elementary School	Original Year of Construction:	1953

3 - Building Component Evaluation Worksheet

Building Structures:

Type:

Load Bearing Masonry

Building Structures Remarks:

There are some cracks present at the gymnasium that have been caulked and painted over where the block have shifted out of the plane of the wall.

Overall Building Structure Condition:

3-Average

Floor Structures:

Steel Joist/Concrete (floor area SF):

18,800

Wood Joists (floor area SF):

Slab on Grade (floor area SF):

45,842

Other (specify) / Floor area SF:

Floor Structure Remarks:

Overall Floor Structure Condition:

3-Average

Roof:

Roof Structure:

Steel Joists

Roof Structures Remarks:

Overall Roof Condition:

3-Average

Building Systems:

The systems below are addressed in the FCA data collection tool.

Roof Coverings

Wall Finishes

Ceiling Finishes

Floor Finishes

Doors

Windows

HVAC

Electrical

Fire Alarm

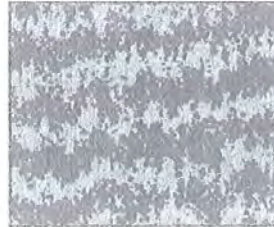

Technology Infrastructure:

Sufficient Electrical Capacity:

Yes

2-Below Average

Power Receptacles Availability:

Yes

2-Below Average

ID Network Type (if available):		4-Above Average
Inventory Records Hardware		4-Above Average
Other (specify):		
Deficiencies:		
Technology Remarks:		
Overall Technology Infrastructure Condition:	2-Below Average	

Technology Assessment:

Teacher Training:	4-Above Average
Software Use:	4-Above Average
Purchasing Practices:	4-Above Average
Network Administration:	4-Above Average
Inventory Records	4-Above Average
Other (specify):	
Deficiencies:	
Technology Remarks:	
Overall Technology Condition:	4-Above Average

School Access Safety Audit:

Planning:	
Deterrence:	
Detection:	
Delay:	
Communication:	
Evacuation:	
Safety Remarks:	
Overall Access Safety Condition:	

School Building Authority of West Virginia
 SBA Form 134 Data Collection Form
 Facility Spaces Evaluation / Utilization Analysis Sheet

LEA ID: 039280 Assessment Date: 4/3/15
 County: Kanawha Total Gross Square Feet: 64,642
 Facility Name: Bridgeview Elementary School Original Year of Construction: 1953

Classroom Type	Grade Config		Age of Facility	No. of Renovations	Square Ft	Portables	Location (City, St)	Utilization Calculation
	PK - 5	6 - 12						
Pre-Kindergarten (Full Day)	1		67		64,642	0	South Charleston, WV	Current Enrollment 446
Kindergarten (Full Day)	3							Total Program Capacity 659
General Purpose Classroom	21							
Computer Lab	n/a							
Art Lab	n/a							
Music Classroom	n/a							
Special Ed Pull-out	n/a							
Special Ed Level 1: (PK-5)	1							
Special Ed Level 1: (6-12)	n/a							
Special Ed Level 2: (PK-12)	4							
Special Ed Level 3: (PK-12)	0							
Special Education Classroom	0							
Technical Education/ Voc Ag	n/a							Utilization Calculation 68%
Physical Education	n/a							Desirable Utilization 85%
Science Classroom/Lab	n/a							
Business Education	n/a							
Family Liv/Cons Economics	n/a							
Totals	30	0	0	0	0	0	0	659 Difference -17%

Complete ONLY the column below associated with the highest grade level for this school.

School Building Authority of West Virginia
SBA Form 134 Data Collection Form
School Improvement Cost Summary Sheet

LEA ID:	039280	Assessment Date:	10/21/19
County:	Kanawha	Total Gross Square Feet:	64642
Facility Name:	Bridgeview Elementary School	Original Year of Construction:	1953
Design Capacity Enrollment:	659		

Please note, the current-year costs shown below are intended to provide a Rough Order of Magnitude (ROM) estimate of costs. While they are appropriate for high-level capital forecasting, they should not be relied upon for determining specific project funding values. Actual project costs will likely deviate from the presented values due to a variety of factors including, but not limited to, hard and soft cost fluctuations and the actual date of construction for the intended project. Therefore, detailed cost estimates are recommended to validate funding requirements prior to obligating funds for facility replacement or renovation.

Improvement Item	Unit	Quantity	Unit Cost	Item Cost	Remarks
1. Site Work					
Land Acquisition	Acres			\$ -	
Excavation/Grade	CUB FT			\$ -	
Drainage	LIN FT			\$ -	
Walks (6 ft wide)	SQ FT			\$ -	
Parking	SQ FT			\$ -	
Bus Loading	SQ FT			\$ -	
Roads	SQ FT			\$ -	
Playing Fields	SQ FT			\$ -	
Other (Describe in 'Remarks')				\$ -	
Other (Describe in 'Remarks')				\$ -	
Other (Describe in 'Remarks')				\$ -	
Sub-Total				\$ -	

Improvement Item	Unit	Quantity	Unit Cost	Item Cost	Remarks
2. Renovations, Exterior					
Wall Structure	SQ FT			\$ -	
Floor Structure	SQ FT			\$ -	
Roof Structure	SQ FT			\$ -	
Wall Facing	SQ FT			\$ -	
Windows	EACH			\$ -	
Doors/Frames	EACH			\$ -	
Roofing	SQ FT			\$ -	
Coping/Parapet	LIN FT			\$ -	
Painting	SQ FT			\$ -	
Other (Describe in 'Remarks')				\$ -	
Other (Describe in 'Remarks')				\$ -	
Other (Describe in 'Remarks')				\$ -	
Sub-Total				\$ -	

Improvement Item	Unit	Quantity	Unit Cost	Item Cost	Remarks
3. Renovations, Interior					
Floor Covering	SQ FT			\$ -	
Patch & Painting	SQ FT			\$ -	
Ceiling Finish	SQ FT			\$ -	
Plumbing	SQ FT			\$ -	
Heating/Ventilating	SQ FT	64,642	\$ 40.00	\$ 2,585,680.00	
Air Conditioning	SQ FT			\$ -	
Lighting	SQ FT	64,642	\$ 12.00	\$ 775,704.00	
Wiring	SQ FT			\$ -	
Fire Alarm	SQ FT	64,642	\$ 4.00	\$ 258,568.00	
Communication System Technology	SQ FT			\$ -	
Interior Doors	EACH			\$ -	
Other (Describe in 'Remarks')	SQ FT	64,642	\$ 5.00	\$ 323,210.00	CONTROLS
Other (Describe in 'Remarks')				\$ -	
Other (Describe in 'Remarks')				\$ -	
Sub-Total				\$ 3,943,162.00	

Improvement Item	Unit	Quantity	Unit Cost	Item Cost	Remarks
4. Building Additions Including Furniture, Furnishings & Equipment					
Administration (ES, MS, HS)	SQ FT			\$ -	
Student Services (ES, MS, HS)	SQ FT			\$ -	

Kindergarten (ES)	SQ FT			\$ -	
Primary (ES)	SQ FT			\$ -	
Media Center (ES)	SQ FT			\$ -	
Basic (MS, HS)	SQ FT			\$ -	
Reading (MS, HS)	SQ FT			\$ -	
Health Education (MS, HS)	SQ FT			\$ -	
Computer Lab (ES, MS, HS)	SQ FT			\$ -	
Inst. Mat. Center (MS, HS)	SQ FT			\$ -	
Home Economics (MS, HS)	SQ FT			\$ -	
Art (ES, MS, HS)	SQ FT			\$ -	
Ind. Technology (MS, HS)	SQ FT			\$ -	
Music (ES, MS, HS)	SQ FT			\$ -	
Physical Education (MS, HS)	SQ FT			\$ -	
Auditorium (MS, HS)	SQ FT			\$ -	
Special Education (ES, MS, HS)	SQ FT			\$ -	
Multi-Purpose (ES)	SQ FT			\$ -	
Kitchen (ES, MS, HS)	SQ FT			\$ -	
Dining (MS, HS)	SQ FT			\$ -	
Business Education (MS)	SQ FT			\$ -	
Co-Op Education (MS)	SQ FT			\$ -	
Drivers Education (MS)	SQ FT			\$ -	
Staff/Faculty (ES, MS, HS)	SQ FT			\$ -	
Toilets/Fixtures (ES, MS, HS)	SQ FT			\$ -	
Storage General (ES, MS, HS)	SQ FT			\$ -	
Storage Instructional (ES, MS, HS)	SQ FT			\$ -	
Custodial (ES, MS, HS)	SQ FT			\$ -	
Mechanical (MS, HS)	SQ FT			\$ -	
Other (Describe in 'Remarks')	SQ FT	750	\$ 307.00	\$ 230,250.00	SAFE SCHOOL ENTRANCE
Other (Describe in 'Remarks')				\$ -	
Other (Describe in 'Remarks')				\$ -	
Subtotal of Building Additions (SQ FT)		750			
Circulation	30%	225	\$ 307.00	\$ 69,075.00	
Sub-Total				\$ 299,325.00	

5. Special Construction	Unit	Quantity	Unit Cost	Item Cost	Remarks
Elevator	EACH			\$ -	
Sprinkler Systems	SQ FT	64,642	\$ 7.00	\$ 452,494.00	
Kitchen Equipment	ALL			\$ -	
Waste Treatment	EACH			\$ -	
Other (Describe in 'Remarks')				\$ -	
Other (Describe in 'Remarks')				\$ -	
Other (Describe in 'Remarks')				\$ -	
Sub-Total				\$ 452,494.00	

6. Other Special Costs	Quantity	Unit Cost	Item Cost	Remarks
			\$ -	
			\$ -	
			\$ -	
Sub-Total			\$ -	
Sub-Total of Items 1 through 6			\$ 4,694,981.00	

7. Architectural/Engineering Fees	%	Quantity	Item Cost	Remarks
New Construction			\$ -	
Renovations	7.0%	\$4,694,981.00	\$ 328,648.67	
Sub-Total			\$ 328,648.67	

8. Miscellaneous	Unit	Quantity	Unit Cost	Item Cost	Remarks
Survey	EACH			\$ -	
Soil Inv.	EACH			\$ -	
Other (Describe in 'Remarks')				\$ -	
Other (Describe in 'Remarks')				\$ -	
Other (Describe in 'Remarks')				\$ -	
Sub-Total				\$ -	

9. Contingencies	%	Quantity	Item Cost	Remarks
New Construction			\$ -	

Renovations	6.0%	\$4,694,981.00	\$ 281,698.86
Sub-Total			\$ 281,698.86

Grand Total Project Cost	\$ 5,305,328.53		
---------------------------------	------------------------	--	--

Worksheet Links:

- [Campus Information](#)
- [Building 1](#)
- [Building 2](#)
- [Building 3](#)
- [Building 4](#)

Reference Data from Prior Sheets (for WVDE Use Only):

Energy Utilization Index:	86,516
Current Enrollment:	446
Program Capacity:	659
Utilization Calculation:	68%
Building(s) in Floodplain/Floodway:	0

Appendix of Supporting Data

County Procedures

4. Proof of Public Hearings

Notice For :

George C. Weimer Elementary School

Alban Elementary School

Bridgeview Elementary School

George C. Weimer



Elementary School

3040 Kanawha Terrace St. Albans, West Virginia 25177 Mrs. Pamela Snead, Principal (304)722-0205

May 8, 2023

George C. Weimer has received from Kanawha County Schools, closure documents. These documents have been made available to the staff and community to view. The documents have also been shared with our LSIC members as well as PTO members.

Pamela D. Snead, Ed M.A.

Principal



KANAWHA COUNTY SCHOOLS



Alban Elementary School

2030 Harrison Avenue

St. Albans, WV 25177

Johnna Jacobs

Principal

Phone

304-722-0234

May 8, 2023

Dr. Williams,

I received the closure documents and made them available for the staff and public to view.

Sincerely,

A handwritten signature in black ink that reads 'Johnna Jacobs'. The signature is written in a cursive style with a large initial 'J'.

Johnna Jacobs

Alban Elementary Principal

Bridgeview Elementary

5100 Ohio Street * South Charleston WV 25309 * 304-766-0383

Stephenie Haynes
Principal

Julie Francis
V Principal

Angela Perry
Secretary

May 8, 2023

To Whom It May Concern:

Bridgeview Elementary received the Reasons and Supporting Data for the Closure of George C. Weimer Elementary School into Alban Elementary School and Bridgeview Elementary School binder. This binder was made available to families and staff in the school office.

Sincerely,

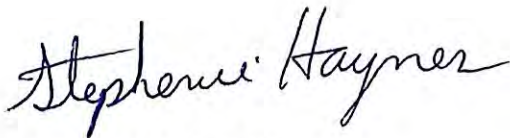

Stephenie Haynes

Affidavit of Legal Publication and Posting

STATE OF WEST VIRGINIA

COUNTY OF Kanawha, TO-WIT

I Janice Alston, Classified Advertising

Representative of the The Charleston Gazette-Mail, a newspaper published in the county of Kanawha, West Virginia, hereby certify that the annexed publication was inserted in said newspaper The Charleston Gazette-Mail.

The cost of publishing said annexed advertisement as aforesaid was \$ 312.50

Commencing On: 04/04/2023

Ending On: 04/25/2023

Given under my hand this day 04/25/2023

Sworn to and subscribed before me 04/25/2023 at Charleston, Kanawha County, West Virginia

Janice Alston
Notary Public of, in and for Kanawha County, West Virginia

MY COMMISSION EXPIRES: 2/14/2027



Janice Alston

NOTICE OF PUBLIC HEARING

**Kanawha County Schools
W. Va. 18-5-13a
W. Va. Board of Education
Policy 6204**

DATE and TIME:

May 4, 2023
at 6:00 p.m.

Sign in between 5:00 and 5:55 p.m. to speak

ALTERNATIVE DATE and TIME: If, in the event of inclement weather or other factors beyond the control of the board, the hearing cannot take place at the date and time set forth above, the hearing will be held on May 11, 2023, at 6:00 p.m.

PLACE: St. Albans High School Auditorium, 2100 Kanawha Terrace, St. Albans, WV 25177. The hearing location is subject to change if, at the time the meeting is called to order, it is determined that the meeting location is of insufficient size to accommodate those wishing to attend.

The hearing may not continue beyond 11:00 p.m. In the event the hearing is not concluded by 11:00 p.m., the hearing may recess, to continue on dates designated and announced by the board just prior to the hearing recess, to be continued day-to-day until concluded.

Proposed Action of the Board of Education of the County of Kanawha, West Virginia:

George C. Weimer Elementary School - Close and transfer of students to Alban Elementary and Bridgeview Elementary.

Hearing Procedures:

A representative of Kanawha County Schools will provide an oral summary of the reasons and supporting data in connection with the proposed action of the Board. For a period of fifty-five minutes prior to the commencement of the public hearing, persons may sign a register for the purpose of making statements, offering testimony and questioning school officials. Persons wishing to speak about the effects of the proposed closure of George C. Weimer Elementary and consolidation into Alban Elementary and Bridgeview Elementary, as well as those who wish to speak as members of the general public, will be recognized in the order in which they have signed the register. Each person shall be limited to three/five minutes. Written statements may be submitted in lieu of oral statements or testimony and must be submitted prior to the conclusion of the hearing. Any written statement will be given full consideration before the board takes any final action.

Reasons and supporting data available for public inspection: Written reasons and supporting data in connection with the proposed action of the Board are available for public inspection beginning March, 29, 2023, through May 4, 2023, between the hours of 7:30 a.m. and 4:00 p.m. in the Office of the Superintendent of Kanawha County Schools located in Room 222, 200 Elizabeth Street, Charleston, West Virginia. The reasons and the supporting data in connection with the proposed actions are also available for inspection at George C. Weimer Elementary, Alban Elementary and Bridgeview Elementary.

LC-149697
04-04,11,18;2023

NOTICE OF PUBLIC HEARING

**Kanawha County Schools
W. Va. 18-5-13a
W. Va. Board of Education
Policy 6204**

DATE and TIME:

May 4, 2023
at 6:00 p.m.

Sign in between 5:00 and 5:55 p.m. to speak

ALTERNATIVE DATE and TIME:

If, in the event of inclement weather or other factors beyond the control of the board, the hearing cannot take place at the date and time set forth above, the hearing will be held on May 11, 2023, at 6:00 p.m.

PLACE:

St. Albans High School Auditorium, 2100 Kanawha Terrace, St. Albans, WV 25177. The hearing location is subject to change if, at the time the meeting is called to order, it is determined that the meeting location is of insufficient size to accommodate those wishing to attend.

The hearing may not continue beyond 11:00 p.m. In the event the hearing is not concluded by 11:00 p.m., the hearing may recess, to continue on dates designated and announced by the board just prior to the hearing recess, to be continued day-to-day until concluded.

Proposed Action of the Board of Education of the County of Kanawha, West Virginia:

Proposed Action of the Board of Education of the County of Kanawha, West Virginia:

George C. Weimer Elementary School -
Close and transfer of

students to Alban Elementary and Bridgeview Elementary.

Hearing Procedures:

A representative of Kanawha County Schools will provide an oral summary of the reasons and supporting data in connection with the proposed action of the Board. For a period of fifty-five minutes prior to the commencement of the public hearing, persons may sign a register for the purpose of making statements, offering testimony and questioning school officials. Persons wishing to speak about the effects of the proposed closure of George C. Weimer Elementary and consolidation into Alban Elementary and Bridgeview Elementary, as well as those who wish to speak as members of the general public, will be recognized in the order in which they have signed the register. Each person shall be limited to three/five minutes. Written statements may be submitted in lieu of oral statements or testimony and must be submitted prior to the conclusion of the hearing. Any written statement will be given full consideration before the board takes any final action.

Reasons and supporting data available for public inspection:

Written reasons and supporting data in connection with the proposed action of the Board are available for public inspection beginning March, 29, 2023, through May 4, 2023, between the hours of 7:30 a.m. and 4:00 p.m. in the Office of the Superintendent of Kanawha County Schools located in Room 222, 200 Elizabeth Street, Charleston, West Virginia. The reasons and the supporting data in connection with the proposed actions are also available for inspection at George C. Weimer Elementary, Alban Elementary and Bridgeview Elementary.

LC-149697
04-04,11,18;2023

**NOTICE OF
PUBLIC HEARING**

**Kanawha County
Schools
W. Va. 18-5-13a
W. Va. Board of
Education
Policy 6204**

DATE and TIME:

May 4, 2023
at 6:00 p.m.

**Sign in between 5:00
and 5:55 p.m. to speak**

**ALTERNATIVE DATE
and TIME:** If, in the
event of inclement
weather or other factors
beyond the control of
the board, the hearing
cannot take place at the
date and time set forth
above, the hearing will
be held on May 11,
2023, at 6:00 p.m.

PLACE: St. Albans High
School Auditorium,
2100 Kanawha Terrace,
St. Albans, WV 25177.
The hearing location is
subject to change if, at
the time the meeting is
called to order, it is
determined that the
meeting location is of
insufficient size to ac-
commodate those wish-
ing to attend.

The hearing may not
continue beyond 11:00
p.m. In the event the
hearing is not concluded
by 11:00 p.m., the
hearing may recess, to
continue on dates desig-
nated and announced by
the board just prior to
the hearing recess, to
be continued day-to-day
until concluded.

**Proposed Action of
the Board of Educa-
tion of the County of
Kanawha, West
Virginia:**

**George C. Weimer
Elementary School** -
Close and transfer of
students to Alban
Elementary and Bridge-
view Elementary.

Hearing Procedures:

A representative of
Kanawha County
Schools will provide an
oral summary of the
reasons and supporting
data in connection with
the proposed action of
the Board. For a period
of fifty-five minutes prior
to the commencement
of the public hearing,
persons may sign a
register for the purpose
of making statements,
offering testimony and
questioning school offi-
cials. Each school com-
munity will have
separate/individualized
times to speak regard-
ing their school's infor-
mation. Persons wishing
to speak about the
effects of the proposed
closure of George C.
Weimer Elementary and
consolidation into Alban
Elementary and Bridge-
view Elementary, as well
as those who wish to
speak as members of
the general public, will
be recognized in the
order in which they have
signed the register.
Each person shall be
limited to three/five
minutes. Written state-
ments may be submit-
ted in lieu of oral
statements or testimony
and must be submitted
prior to the conclusion
of the hearing. Any
written statement will be
given full consideration
before the board takes
any final action.

**Reasons and support-
ing data available for
public inspection:**

Written reasons and sup-
porting data in connec-
tion with the proposed
action of the Board are
available for public in-
spection beginning
March, 29, 2023,
through May 4, 2023,
between the hours of
7:30 a.m. and
4:00 p.m. in the Office
of the Superintendent of
Kanawha County
Schools located in
Room 222, 200 Eliza-
beth Street, Charleston,
West Virginia. The rea-
sons and the supporting
data in connection with
the proposed actions
are also available for
inspection at George C.
Weimer Elementary, Al-
ban Elementary and
Bridgeview Elementary.

LC-149697
04-04,11,18,25;2023

NOTICE OF PUBLIC HEARING

**Kanawha County Schools
W. Va. 18-5-13a
W. Va. Board of Education
Policy 6204**

DATE and TIME:

May 4, 2023
at 6:00 p.m.

Sign in between 5:00 and 5:55 p.m. to speak

ALTERNATIVE DATE and TIME:

If, in the event of inclement weather or other factors beyond the control of the board, the hearing cannot take place at the date and time set forth above, the hearing will be held on May 11, 2023, at 6:00 p.m.

PLACE: St. Albans High School Auditorium, 2100 Kanawha Terrace, St. Albans, WV 25177. The hearing location is subject to change if, at the time the meeting is called to order, it is determined that the meeting location is of insufficient size to accommodate those wishing to attend.

The hearing may not continue beyond 11:00 p.m. In the event the hearing is not concluded by 11:00 p.m., the hearing may recess, to continue on dates designated and announced by the board just prior to the hearing recess, to be continued day-to-day until concluded.

Proposed Action of the Board of Education of the County of Kanawha, West Virginia:

George C. Weimer Elementary School - Close and transfer of students to Alban Elementary and Bridgeview Elementary.

Hearing Procedures:

A representative of Kanawha County Schools will provide an oral summary of the reasons and supporting data in connection with the proposed action of the Board. For a period of fifty-five minutes prior to the commencement of the public hearing, persons may sign a register for the purpose of making statements, offering testimony and questioning school officials. Each school community will have separate/individualized times to speak regarding their school's information. Persons wishing to speak about the effects of the proposed closure of George C. Weimer Elementary and consolidation into Alban Elementary and Bridgeview Elementary, as well as those who wish to speak as members of the general public, will be recognized in the order in which they have signed the register. Each person shall be limited to three/five minutes. Written statements may be submitted in lieu of oral statements or testimony and must be submitted prior to the conclusion of the hearing. Any written statement will be given full consideration before the board takes any final action.

Reasons and supporting data available for public inspection:

Written reasons and supporting data in connection with the proposed action of the Board are available for public inspection beginning March 29, 2023, through May 4, 2023, between the hours of 7:30 a.m. and 4:00 p.m. in the Office of the Superintendent of Kanawha County Schools located in Room 222, 200 Elizabeth Street, Charleston, West Virginia. The reasons and the supporting data in connection with the proposed actions are also available for inspection at George C. Weimer Elementary, Alban Elementary and Bridgeview Elementary.

LC-149697
04-04,11,18,25;2023

Appendix of Supporting Data

County Procedures

5. Public Hearing Documentation

Notice For :

George C. Weimer Elementary School

Alban Elementary School

Bridgeview Elementary School

PUBLIC HEARING ON THE SCHOOL CLOSURE OF GEORGE C. WEIMER
ELEMENTARY

Thursday, May 4, 2023

VISITOR SIGN-IN SHEET

Hannah Carbin - wchs
Sarah Bukovinsky - weimer elem.
Georgiana Drozda - Weimer Elem
April Koontz - Weimer
Linda Monday weimer
Kay Atkins - weimer
Andres Solis - Weimer
Kecy Martine? - Weimer
Olena Kocicova - Weimer
Pam Shead Weimer
Ashley Nolascki Weimer
David Nolascki - guest of Weimer
Kim Cochran - weimer
Kimberly & Bill Ferrell
Josh Ewers
Sarah McGrath - Weimer
Julie Ramsey - Weimer
Samantha Dolson - weimer
Emma Ellis -
MaryBeth Rice - Weimer
Holli Rice - Weimer
Brandi Starcher - Weimer
Jessie Caber - weimer
Jesslyn Aymt - WEIMER
Cindi Settle -
Nancy Michael
Beth Brannon
Carolyn Hess
Jarett Lewis Metro News

PUBLIC HEARING ON THE SCHOOL CLOSURE OF GEORGE C. WEIMER ELEMENTARY

SPEAKERS TO ADDRESS THE BOARD
FROM GEORGE C. WEIMER ELEMENTARY

Thursday, May 4, 2023
St. Albans High School

1. ✓ Megan Gillispie
2. ✓ Carrie Miller
3. ✓ Daniella Martinez
4. ✓ Alisa Horielova
5. ✓ Sarah Newett
6. ✓ Nichole Stephenson
7. ✓ Wayne Stephenson
8. ✓ Cary Hess
9. ✓ Summer Drake
10. ✓ Amber Brown
11.
12.
13.
14.
15.
16.
17.
18.
19.
20.

PUBLIC HEARING ON THE SCHOOL CLOSURE OF GEORGE C. WEIMER ELEMENTARY

SPEAKERS TO ADDRESS THE BOARD

FROM ALBAN ELEMENTARY

Thursday, May 4, 2023

St. Albans High School

✓ 1. Johanna Jacobs
2.
3.
4.
5.
6.
7.
8.
9.
10.
11.
12.
13.
14.
15.
16.
17.
18.
19.
20.

PUBLIC HEARING ON THE SCHOOL CLOSURE OF GEORGE C. WEIMER ELEMENTARY

SPEAKERS TO ADDRESS THE BOARD

FROM BRIDGEVIEW ELEMENTARY

Thursday, May 4, 2023

St. Albans High School

1.	Stepherie Haynes
2.	
3.	
4.	
5.	
6.	
7.	
8.	
9.	
10.	
11.	
12.	
13.	
14.	
15.	
16.	
17.	
18.	
19.	
20.	

To Whom it May Concern:

April 24, 2023

I taught at George C. Weimer Elementary for five years. During my time there I experienced some of the best years of my career of 30 years. Mrs. Snead is a fantastic principal. She has done wonders bringing Weimer to a school of excellence. Weimer Elementary is a haven for many students in that area of the county. It is a place with teachers and staff full of love and commitment for these students. Many of these students experience much trauma in their lives and they do not have caring adults around them. Because of the size of the school, Weimer is able to feel like a family to them. This is the family that they do not have at home. I remember several times as the end of the year was nearing hearing students say that they did not want summer to come because they would not be coming to school. There were tears from many as well. These were not your typical children who "loved" school. They were they students who needed the school. Weimer Elementary also has many activities that help to bring the families into their children's education and lives. I am asking that you do not close Weimer Elementary School. The students and families in the St. Albans area need this school.

Sincerely,

Mrs. Becky Ryder

**Reading Specialist at Glen Dale
Elementary in Marshall County**

DEBRA LEWIS

To: THOMAS WILLIAMS
Subject: RE: Weimer Elementary

Good morning Dr. Williams,

As a community leader in St. Albans, I am emailing you in regards to Weimer Elementary. I have been a mentor for this school throughout the years. Today, I will meet with 50 of their students and teach financial literacy, which is so needed in our schools.

This is a poverty area school and most of these children are being raised by grandparents/family members/foster homes. These children need more one on one teaching and direction and the staff at Weimer do a fantastic job at this. By closing this school and moving children into other areas, the impact could be detrimental to them. I fear they would be lost in the transition and their mental health would be impacted. We really need for Weimer to continue to operate and give these students the attention they so desire.

From one St. Albans supporter to another, please re-consider your decision and **do not** consolidate Weimer Elementary. The principal and staff do amazing work with the students and in our community.

Best regards,

Christy Scott
Vice President
Branch Manager
NMLS ID #1377280
560 4th Street
St. Albans, WV 25177
304.722-7565 (phone)
304.722-7579 (fax)



Confidentiality Notice: The information contained in this e-mail and any attached documents may be confidential or legally privileged. It is intended exclusively for the individual or entity to which it is addressed. This communication may contain information that is proprietary, privileged or confidential or otherwise legally exempt from disclosure. If you are not the named addressee, you are not authorized to read, print, retain, copy or disseminate this message or any part of it. If you have received this message in error, please notify the sender immediately by e-mail and delete all copies of the message. Please note that the sender accepts no responsibility for viruses and it is your responsibility to scan this e-mail and attachments (if any). No contracts may be concluded on behalf of the sender by means of electronic communications unless expressly stated to the contrary.

DEBRA LEWIS

Subject: FW: Please don't close our school

From: Weimer Wildcat PBIS Team <weimerwildcats@gmail.com>

Subject: Please don't close our school

Date: May 4, 2023 at 10:55:27 AM EDT

To: Tw4ourkids@gmail.com, beckyjj16@aol.com, rwhite@whitepllc.com, riccavenderboe@gmail.com, jmcrawford@suddenlink.net, twilliams@mail.kana.k12.wv.us

Dear Board Members,

Please don't close our school. It is a very lovely place to learn. We are including some pictures of letters the student council and other students have written.

Have a nice day,

Conner Mackenzie

sent with help from Mrs. Sarah the counselor

_IMG_0801.HEIC

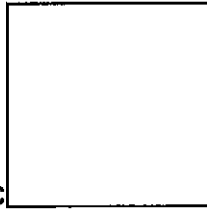

To Whom it May Concern:

April 24, 2023

I taught at George C. Weimer Elementary for five years. During my time there I experienced some of the best years of my career of 30 years. Mrs. Snead is a fantastic principal. She has done wonders bringing Weimer to a school of excellence. Weimer Elementary is a haven for many students in that area of the county. It is a place with teachers and staff full of love and commitment for these students. Many of these students experience much trauma in their lives and they do not have caring adults around them. Because of the size of the school, Weimer is able to feel like a family to them. This is the family that they do not have at home. I remember several times as the end of the year was nearing hearing students say that they did not want summer to come because they would not be coming to school. There were tears from many as well. These were not your typical children who "loved" school. They were they students who needed the school. Weimer Elementary also has many activities that help to bring the families into their children's education and lives. I am asking that you do not close Weimer Elementary School. The students and families in the St. Albans area need this school.

Sincerely,

Mrs. Becky Ryder

Reading Specialist

Dear School Board Member,

I don't want Weimer Elementary closed. My first reason is I like specials. I'm an activity guy and gym class is my favorite. Another reason Weimer Elementary should not be closed is the people who work here are nice and I like my friends. I joke a lot around my friends Jonah, Seneca, Peyton, and Michael and sometimes they joke around with me. These are two reasons why you should not close Weimer Elementary.

Sincerely,

Kadan

Dear Board Members,

I think Weimer should remain open because it is a good school, has good staff, and good classes.

Weimer Student,

Leland

Leland Roush

5th Grade Student

Dear Board Members,

Weimer should remain open because everyone is great here and the younger students have no school to go to. Our students need smaller classes so they can be more successful.

Weimer Student,

Jackson Smith

Dear School Board Members,

Please don't shut down Weimer. Think about how many friends you'll separate while you're tearing down our favorite school. I hope you get this letter. Please don't tear down Weimer.

Sincerely,

Seneca Parker

Dear Board Members,

I think Weimer should stay open because it has a lot of good students. Students that have been here since kindergarten.

Weimer Student,

hunter waller

Hunter Waller

Dear Board Members,

Weimer is a great school in my opinion. I think it should stay open. Everyone at our school is super nice and helpful. Geoffrey and I love this school. There is lots of room for improvement, but for the most part this school is a really good school. There is no room for Weimer to get split up. The two schools where Weimer will get split up into already has too many kids in them. In Weimer, students are more able to have one on one for help. I love Weimer. I do not want it to get shut down.

Weimer Student,

Zoey Reveal

5th Grade Student

Dear School Board Member,

In my opinion you should not close Weimer Elementary. One reason you should not close it is because it's a good school. It is cool and fun. The second reason is Mrs. Snead and Mrs. LeaAnn work hard. They take care of us and help us. These are my reasons why you should keep Weimer Elementary.

Sincerely,
Zahmay

Dear School Board Member,

In my opinion Weimer Elementary should not be closed. My first reason is I like it here. I've been here since pre-k. Also, there are some nice teachers here. My second reason is I feel safe when something happens, because the teachers take care of the students like our parents.

Sincerely,

Bentlee

Dear Board Members,

I think Weimer should stay open because smaller kids will be uncomfortable in the new school. Other schools are bigger and younger kids can get messed up. Most of the students are used to the teachers and it's hard to change them.

I feel that Weimer is my second home. All the teachers are nice to me and I am friends with them. I would miss this school.

Weimer Student,

Alisa Horielova

5th Grade Student

The George C. Weimer Elementary Student Council
3040 Kanawha Terrace St. Albans, WV 25177
(304) 722-0205

April 24th, 2023

To Whom it May Concern,

We are writing this letter in the hopes that you will hear our voices regarding the matter of potentially closing our school. We have developed a list of reasons for why our school should remain opened, along with some cherished memories during our time at Weimer Elementary.

"I have been here only 1 year, but I feel that this is my second home." These words came from one of our fellow members on the topic of possible consolidation. She transferred in from another country to escape the happenings going on around her. She has found comfort in our school, built relationships with staff members and students alike, and represented our school in numerous capacities all in one year. This is a testament to how Weimer was able to embrace a student from another country and treat her as if she has always been a part of us. Other members unanimously agreed that the small class sizes and homey-feel provide the majority of the students great comfort here at Weimer Elementary. Fifth grade students specifically expressed their concern about students getting "lost" and "forgotten" should they have to transition to a larger school. The small student population at Weimer allows teachers and students to build stronger relationships that last well beyond when they leave a particular grade level. However, the students aren't just concerned about themselves and their classmates, they are concerned about teachers as well. "Teachers would lose their jobs and then would have to find another job", noted another one of our members. The students here at Weimer are so close to their teachers that they are truly concerned about their well-being and livelihood. As our members were considering other reasons to not close our school, we reminisced on all of the prior events and happenings that have taken place at our school over the years. Box tab fundraisers, book giveaways, family nights, concerts, field trips, guest speakers, and more were all mentioned as memories that students have loved and appreciated. Another aspect of our school that students take great pride in is our school mantra which is R.O.A.R. Our members discussed how they are able to see our school as a community that is working together on these expectations through our weekly assemblies. Every Wednesday, students at Weimer all joined for a behavior-based, celebratory assembly in an effort to further build our connections and purpose here with one another. These gatherings also provided our members and other students alike with leadership opportunities that will support their development for years to come.

We say all of this to show you that our school needs to remain opened. Even though we have had all of this great support and memories here at Weimer Elementary, we want that opportunity to be given to future students here at our school. Keeping Weimer Elementary open will protect a gem that is a safe-haven to our little community and to our kids.

Signed,

The George C. Weimer Elementary Student Council

Dear School Board Member,

In my opinion you should not close Weimer Elementary. My first reason is I have been here for five years. I met my friends on my journey. My second reason is I have learned so much. This year I learned division. These are my reasons to not close Weimer Elementary.

Sincerely,

Michael

Appendix of Supporting Data

County Procedures

6. Board Minutes

Board minutes indicating the action of the board to approve the closure:



200 Elizabeth Street, Charleston, West Virginia 25311-2119 (304) 348-7732 Fax (304) 348-7735

-AGENDA-

SPECIAL SESSION

PUBLIC HEARING ON SCHOOL CLOSURE

(George C. Weimer Elementary)

Thursday, May 4, 2023, 6:00 p.m.

**St. Albans High School
2100 Kanawha Terrace
St. Albans, WV 25177**

- I. CALL TO ORDER**
- II. ADMINISTRATION'S PRESENTATION**
- III. SPEAKERS WHO HAVE SIGNED UP TO ADDRESS THE BOARD FROM GEORGE C. WEIMER ELEMENTARY**
- IV. SPEAKERS WHO HAVE SIGNED UP TO ADDRESS THE BOARD FROM ALBAN ELEMENTARY**
- V. SPEAKERS WHO HAVE SIGNED UP TO ADDRESS THE BOARD FROM BRIDGEVIEW ELEMENTARY**

MINUTES

The Board of Education of the County of Kanawha

Charleston, West Virginia 25311



May 4, 2023

The Board of Education of the County of Kanawha met in Special Session on Thursday, May 4, 2023 at St. Albans High School, St. Albans, West Virginia. The meeting was called to order by Board President Tracy White at 6:00 p.m.

PRESENT

Tracy White, President

Ric Cavender, President Pro Tem

Jim J. Crawford, Sr.

Becky J. Jordon (via phone)

Ryan White

Thomas E. Williams, Secretary

Debra J. Lewis, Recording Secretary

ADMINISTRATIVE STAFF

Paula Potter, Deputy Superintendent

Lindsey McIntosh, General Counsel

Ron Pauley, Executive Director, Human Resources

Megan McCorkle, Asst. Superintendent, Special Education & Student Support Services

Melissa Rider-Wilfong, Director, Title I

Andrew Crawford, Executive Director, Facilities & Planning

Keith Vititoe, Executive Director, Safety & Security

ADMINISTRATION'S PRESENTATION

Dr. Williams-Thank you all for being here this evening. School closures are among the most difficult recommendations that anyone in my position can make. We know that our schools are fixtures in our communities and they mean so much to the areas they serve. We do not take these recommendations lightly and please know that we are here to listen and I know that we will keep the meeting civil and respectful. As many of you know, Kanawha County School's student population is shrinking. In the last 10 years we have lost approximately 4,400 students. The West Virginia Legislature funds school systems based on their number of pupils, therefore, over the last 10 years we have also lost the funding associated with those 4,400 students. That equates to almost 500 positions being lost over the last 10 years and approximately \$29,000,000 in state funding over the same period. The West Virginia Legislature is the only group that can change the state funding formula. In addition to the loss of funding, we are also facing increases in required spending in the area of utilities, waste management, maintenance, and an increase in our mandatory liability insurance. Kanawha County Schools has been very good with budgeting and we have been able to absorb large losses without cutting deeply into schools or programs, but we are at the point now where we cannot continue to cut positions without also consolidating schools. You are probably wondering why my school. When making these difficult recommendations for consolidation this year, I had to first look at the schools that could be consolidated without significant additional costs to the district. The three schools selected were Grandview, Marmet and Weimer. They were selected because there are schools nearby that can accept the students without any additions. Anytime there is a school consolidation there is concern by staff at both the closing school and the accepting school over staff retention and the process. When the staffing transfer season occurs, all staff across the county will vote on whether to give priority ranking to the teachers from Weimer, in this case at Alban and Bridgeview, so if they would have to hire additional teachers at Alban and Bridgeview and the county would vote to give the Weimer teachers priority, then they would have priority and historically in the past that has always happened. Please note that the proposed school closures would not happen immediately. If approved, schools would not see a change until the 2024-25 school year. This would enable a full year of opportunity for closing schools and receiving schools to work together on transition activities where students and parents can attend different events at their new school. We recently went through a similar process with the closure of Cedar Grove Middle and moved those kids into DuPont and it was very successful. As outlined in the meeting notice, speakers will have 5 minutes to speak. If you are unable to get through your remarks or questions in that time or you don't wish to speak, you may submit your written remarks to us. First we will hear from the folks from Weimer and then we will hear from the folks at Alban and Bridgeview.

SPEAKERS WHO HAVE SIGNED UP TO ADDRESS THE BOARD FROM WEIMER ELEMENTARY

Megan Gillispie-I have kids that go to Weimer and I have a little guy that will be attending preschool this fall. My kids have gone to this school since 2013. I worked at the school for two years. They are not just teachers to us, they are family. These are some of the most wonderful teachers and staff that I have ever met. Having such small classes allows these kids to be noticed. I'm not saying that Alban and Bridgeview aren't wonderful, I'm sure they are, but these kids get to have one-on-one with these teachers and they are able to be noticed if they are lacking in academics and if they need that extra love, these teachers see that. Some of these kids don't get the parents that care and these teachers and staff do. Some of these kids have been together since preschool and they will be separated. I tell everyone that Weimer is a hidden gem. I hope you guys will keep the school open.

Carrie Miller-I have a daughter in Weimer. My daughter is special needs and she has severe behavioral issues and had a speech problem and I couldn't understand anything she said. I met with the teacher and told her I was concerned. She told me not to worry and that they would love her and would make it work. Her teachers have done wonderful things. I can now understand what she is saying and she doesn't have any behavioral problems anymore. She is the sweetest thing and it's because of the staff there. She loves it so much. It's better for her to be in a small classroom where she can have one-on-one time. I just would appreciate if you would not close her school down.

Daniella Martinez-How many principals do you know that can stand outside and greet every child by name? My 1st grader is kind of a troubled child. I have broken down and cried with the school counselor concerned with not knowing what to do with my child. Instead of just telling me everything would be okay, she found resources for us and continued to check in on my child. When I think about Weimer, I think about community and inclusiveness and the staff and their love for all those students. I ask you to keep George C. Weimer open.

Alisa Horielova-I feel so much that the school is my second home. This school needs to stay open. Most of the kids are concerned about the transition to a larger school. The students aren't just concerned about themselves they are concerned about the teachers and staff having to find another job. We have so many good things at our school, field trips, guest speakers, concerts and more. All of the students sit on the floor and we talk about how to be responsible, accepting and respectful. We learn how to be nice and kind. We have different dress up days. This school needs to remain open. We want these opportunities to be given to other students, that's why our school should remain open.

SPEAKERS WHO HAVE SIGNED UP TO ADDRESS THE BOARD FROM WEIMER ELEMENTARY
(continued)

Sarah Hewett-I am the counselor at Weimer. It is my 7th year. A lot of our kids have been through a lot of trauma and my biggest concern for them is that they will be lost and no one will know what they have been through and it will be another traumatizing experience for them. I know financially, the most responsible thing for you to do is close schools and consolidate, but if there is any way to keep it open so the kids won't lose stability. I would just ask that you take care of our babies and don't let them be lost. Please make sure that they are taken care of and that they are supported. At the very least, if you are going to close us down, give them extra staff so they have people who are there to care for them. They are used to having teachers who have known them their whole life. Please, if there is any way to keep them together there is something to be said for a small school. I worry that they won't have that love and support somewhere else.

Nichole Stephenson-I am the aunt of a Weimer student. When my sister-in-law said they were moving to West Virginia from Phoenix I picked Weimer for my nephew. I am the mom of two sons who went to a small community school. When Mrs. Snead interviewed me when I brought Kaden in, she specifically asked why I chose Weimer and I said because you are a small school. The class size, the test scores, the small community. The small community of that school will follow those kids. This is a friendship and a family that never goes away. This is what these kids and this community needs. The way to keep your population up is to give these children a sense of community and family. That gives them something to stick around for. You can't look at formulas and headcounts. It doesn't translate to what these children need. Give them a reason to stay. Home starts with Weimer.

Wayne Stephenson-Although my nephew isn't going to be affected by the closure, I'm thinking of our future kids who will attend a small school like Weimer. The opportunities that are presented at Weimer may be more than they get at other locations. When you start adding students to a classroom, it's too easy to get lost. You can't know each individual student and in order to be successful and succeed they need to be given every opportunity like they get at a small school.

Cary Hess-The Board of Education has already decided to close down two schools and now they are considering another and because of this schools will be overcrowded, children will be left behind, teachers will be overworked and members of those closed schools will be laid off. Children in our community will have to experience being the new kid in school. Why is this happening? The truth is the Board of Education doesn't have enough money to keep schools open because the legislative funding is not enough.

SPEAKERS WHO HAVE SIGNED UP TO ADDRESS THE BOARD FROM WEIMER ELEMENTARY
(continued)

The legislature has stabbed us in the back so that is why I am inviting everyone in this room to demand better for our students, educators and school staff. Next Monday from 5-6:00 I am going to have a protest at the State Capitol in the lower rotunda. I want everyone in that building to hear this. Tell everyone you know.

Summer Drake-I actually no longer work at Weimer but they still have my heart. When I think of Weimer the first two letters speak out to me. First, we are like a family. We are a group of hard-working individuals who would stop at nothing to make sure our job is done and every student was reached. The tight-knit small school feel is something that cannot be replaced. We all know that we were there for the kids. We took the time to learn every new curriculum that was thrown at us whether we liked it or not. We got there early and stayed late. We built relationships with family. We begged for help for those kids. You will be losing a great school that has been cherished by families for many years. The county may save money, but at what cost? I hope this decision will not be made lightly.

Amber Brown-I previously worked at Weimer. It was certainly one of the most challenging times of my life because our kids have a lot of needs, but my heart is there. I began to tell people that Weimer was the best kept secret in the county. We did so much. We all worked as a team and a family. I would like to say that we couldn't function without Pam Snead. We worked very hard to get the health bus and Pam spearheaded that. We also worked hard for the track at Weimer with fundraisers and contests to raise thousands of dollars for that.

SPEAKERS WHO HAVE SIGNED UP TO ADDRESS THE BOARD FROM ALBAN ELEMENTARY

Johnna Jacobs, Principal at Alban Elementary-I know there is nothing that I can say tonight to make families feel like you will be okay right at this moment, but if the Board does decide to close down Weimer, I do want you to know that we will love your babies. Pam and I already work together on a lot of things because we do have a lot of the same community members, but we will do everything we can to make your kids feel included and loved and taken care of and we have an amazing staff as well. Pam and I have discussed, just in case, some of the things that both schools can do together so you can meet the teachers and talk to the staff and some of the kids that are there, so this year we planned to have some family nights together and combine some movie nights. We want our kids to grow together. We have talked about joint professional development so that the Weimer teachers can teach the Alban teachers any secrets you may have that we can learn from you about your kids. Some things you may be interested

SPEAKERS WHO HAVE SIGNED UP TO ADDRESS THE BOARD FROM ALBAN ELEMENTARY
(continued)

in about Alban is that we have a guitar club after school, we have multiple outdoor classroom spaces, we have a garden in the back and the vegetables are put on the salad bar that are harvested. We have a wonderful PTO. While nothing I say will make you feel any less sad if Weimer closes, I want you to know that you will be welcomed with open arms at Alban.

SPEAKERS WHO HAVE SIGNED UP TO ADDRESS THE BOARD FROM BRIDGEVIEW ELEMENTARY

Stephenie Haynes, Principal at Bridgeview Elementary-Listening to you all speak I hate feeling like the villain in someone's story. I talk to Pam on a weekly basis. We swap kids back and forth already. If the Board decides to close Weimer one thought that came into my head is I think it would be a good idea for the counselor at Weimer to come and meet with our counselors and have a sit down and share your wealth of knowledge so that if we do indeed bring your babies on board, we will have a head start. Bridgeview has a Communities in Schools Program so we have an extra staff member on hand that is a go-to girl for everything. Through the Communities in Schools Program we have Louie, our service dog. He visits all the classrooms, he greets 400 children every morning. He is a big part of our community. We have a food pantry and a clothing closet. We also have the BARR Program which is building assets and reducing risks. We keep track of children building-wide and we share that information so your babies don't fall through the cracks. Even though Bridgeview is a larger school, we do make those connections with children and if are fortunate enough to absorb your babies, we will make those connections. I do know the names of all 400 children in my building. We will make the best of this situation if this does happen. We will plan family nights to get to know you all.

NEW BUSINESS

A. George C. Weimer Elementary School

Mr. Ric Cavender moved: The Board close George C. Weimer Elementary School at the end of the 2023-24 school year and consolidate students into Alban Elementary and Bridgeview Elementary, for the reasons stated and as described in the closure documents provided to the public. Motion was seconded by Mr. Jim J. Crawford.

NEW BUSINESS (continued)

Mr. Crawford-I've been in this community since 1962. I came to St. Albans High School as a teacher and we had 1,850 kids. The school was busting at the seams. We had St. Albans Jr. High, Hayes and McKinley and they were busting at the seams. Today we are not utilizing the total building. We don't have the students that we did at that time. We don't have the money that we had in those days. What we are trying to do is make this thing work and keep Kanawha County Schools' budget within its means. When I came on the Board in 2000, we were \$10 million dollars in the red. Dr. Duerring and the Board worked to get that erased and it took 3 years to get us back in the black and it hasn't been in the red since then. This Board has a fiduciary responsibility to make sure this system functions in a prudent manner. This consolidation won't cost the Board any money. I don't like closing schools. It's not popular with me or the people in our community but we have to make sure that we do what is right with the taxpayers in this county.

Mr. White-I agree with a lot of the speakers here that it is better to have smaller community schools. Small classrooms is something very desirable. It's unfortunate that we are put in this position. We have a school aid formula based strictly on per capita per student and it doesn't have to be that way. Almost every other state doesn't base their school aid formula on per student it's based on other factors. It's very antiquated. We've asked the legislature to change the school aid formula and they have not done anything to change it. This puts us in a bad situation. It's unfortunate because our state has a \$1.7 billion dollar surplus and it could have been used to help with things like this.

Mr. Cavender-This is by far the toughest thing that the Board is tasked to do. We know that these decisions affect you. Mrs. Hewett had mentioned her special needs daughter and I had a question about how that looks if any special needs student goes to another school. Dr. Williams-Their IEP is transferred and the information is given back and forth between their teachers and Megan and her specialists work and try to make it as smooth as possible. Mr. Cavender-I really appreciate everyone taking the time and sharing your thoughts about this wonderful community school.

Mrs. Jordon-I appreciate everyone coming out this evening and everyone's comments.

Mrs. White-These are probably the hardest decisions that we have had to make. This is when we have to look at you as a community and make a decision and it's not easy. I will say that Weimer was where my son Bailey started Kindergarten in an autism room. Speaking of special education and IEP minutes, I would like to request for any of the schools that we are closing if we could possibly have a day sometime, like we do for our 9th graders when they transition to high school, for all of our students, not just our IEP

NEW BUSINESS (continued)

students in the schools that are closing that they can go see their new school before school begins. I agree with Mr. White, I was there every day at the Capitol with the teachers when they were on strike saying we need small classrooms. That is the best scenario for our kids but we can't do anything about this formula. It doesn't care about what our kids go through in their personal lives, it doesn't care about how many grandparents are raising their kids and then you through COVID. We as a Board have to make hard decisions. I wish we didn't have to. I apologize that we are here and we have to make these decisions.

Dr. Williams-I spent 17 years in this building and when I moved to St. Albans 38 years ago, we had 6 elementary schools just inside the city limits and since that time you all know what has happened. My daughter was in the 4th grade at High Lawn and it was closed and she went to Alban for her 5th grade year. She did well. My wife and I supported her through the process and I know if the Board makes that decision that you all will support your children. I understand how you feel because I have been in your seat before. It's not a good decision to make.

The above motion unanimously carried.

ESTABLISHMENT OF MEETING DATES

- A. Thursday, May 4, 2023, 6:00 p.m.-Special Session (Closure Hearing for George C. Weimer Elementary at St. Albans High School)
- B. Thursday, May 11, 2023, 5:00 p.m.-Regular Session
- C. Tuesday, May 16, 2023, 12:00 Noon-Statutory Session (Approval of the Proposed Budget)
- D. Monday, June 5, 2023, 4:00 p.m.-Special Session
- E. Thursday, June 15, 2023, 5:00 p.m.-Regular Session

NOTE: The above meetings of the Kanawha County Board of Education, unless otherwise indicated, will be held in the Board of Education Building, 200 Elizabeth Street, Charleston, WV.

ADJOURNMENT

Mr. Ric Cavender moved: That the Special Session of the Board be adjourned. Motion was seconded by Mr. Jim J. Crawford and unanimously carried. The Special Session was declared adjourned by Board President Tracy White at 6:58 p.m.

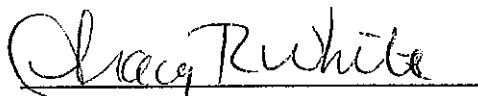

President

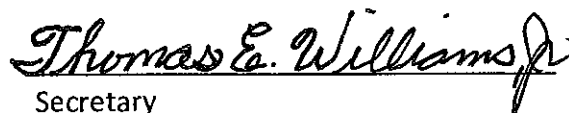

Secretary

djl

5/5/2023

Appendix of Supporting Data

County Procedures

7. Cover Letter

Cover letter addressed to the State Superintendent of Schools:



200 Elizabeth Street, Charleston, West Virginia 25311-2119 • (304) 348-7732 • Fax: (304) 348-7735
Thomas E. Williams, Jr., Ed.D., Superintendent

May 8, 2023

Mr. David Roach
State Superintendent of Schools
WV State Department of Education
1900 Kanawha Boulevard, East
Charleston, WV. 25305

Dear Mr. Roach:

The Kanawha County Board of Education voted unanimously on May 4, 2023, to close George C. Weimer Elementary and merge those students into Alban and Bridgeview Elementaries. The closure of George C. Weimer Elementary would be at the end of the 2023-2024 school year.

Kanawha County Schools is requesting approval of this closure/merger. Please add this agenda item to the June meeting of the State Board of Education.

Kanawha County Schools will also submit a request for an amendment to our current CEFP. I ask that this be placed on the June agenda as well. Supporting documentation is maintained and on file in the Facilities/Planning Office for Kanawha County Schools. Please let me know if you have additional questions.

Sincerely,

Thomas E. Williams, Jr., Ed.D.
Superintendent
Kanawha County Schools

Cc: Micah Whitlow, WVDE Director of School Facilities Services
Andy Neptune, Executive Director, SBA of WV
Andrew Crawford, Executive Director of KCS Facilities/Planning
Lindsey McIntosh, General Council, KCS

Appendix of Supporting Data

County Procedures

8. Superintendent Signature Pages

[Completed Superintendent Signature Pages:](#)

3.0. County Procedures

WVDE Application for school closure and/or consolidation

Kanawha County

Closure of George C. Weimer Elementary School into Alban Elementary School and Bridgeview Elementary School

Scheduled Date of Hearing: Thursday, May 4, 2023 at 6:00 P.M.

Scheduled Date of County Board Vote: Thursday, May 4, 2023 following the Hearing

County Procedures

This template shall be used to accumulate and present the data that is requested in Policy 6204 and W.Va. Code 18-5-13a to support the closure or consolidation of a WV public school.

The county shall prepare written reasons and supporting data concerning proposed school closings or consolidations to be submitted to the WVBE for approval in accordance with this policy and W. Va. Code §18-5-13a. The written materials shall:

- be available for public inspection in the office of the county superintendent during the 30 days preceding the date of the public hearing; and*

Be delivered in duplicate to the:

- principal of a school that is proposed to be closed or consolidated, and of any school which the county designates to receive the students who are relocated as a result of the closure or consolidation; and*
- chair of the local school improvement council (LSIC) representing a school that is proposed to be closed or consolidated, and any school that the county designates to receive the students who are relocated as a result of the closure or consolidation.*
- A copy of the notice shall be posted at all schools, bus garages, and maintenance areas in the county in conspicuous working areas, for all professional and service personnel to observe.*

Thomas E. Williams, Jr., Ed.D.

Superintendent

5-8-2023
Date

3.2.f. Educational Program

County Procedures

Analysis and Assurance of Consideration

Complete a projected educational program improvement analysis which includes a statement of assurance that the following have been considered:

Affected School Name(s)

George C. Weimer Elementary School, Alban Elementary School, and Bridgeview Elementary Schools

In the preparation of the documents regarding the closure and/or consolidation of the above referenced school, the following codes and policies have been considered:

Please check each item that was considered.

- W. Va. 126CSR16, Policy 2419, Regulations for the Education of Students with Exceptionalities,
- W. Va. 126CSR42, Policy 2510, Assuring the Quality of Education: Regulations for Education Programs,
- W. Va. 126CSR44 et al., Policy 2520, Content Standards and Objectives for West Virginia Schools,
- WVBE Policy 6200-Planning of School Facilities
- WVBE Policy 6204-School Closings or Consolidations

Thomas E. Williams, Jr
Superintendent

5-8-2023
Date

3.6.a. Superintendent Verification of Board Actions

County Procedures

George C. Weimer Elementary School, Alban Elementary School, and Bridgeview Elementary School

Date of hearing: Thursday May 4, 2023 at 6:00 P.M.

Date of board approval: Thursday May 4, 2023 following hearing

Kanawha County requests the West Virginia Board of Education approve the following.

Closure and Consolidation of George C. Weimer Elementary School into Alban Elementary School and Bridgeview Elementary School.

- The county assures that the applicable sections of the W. Va. Codes §18-5-13 and §18-5-13a, and WVBE Policies 6200 and 6204 have been addressed.*
- This action is justified by the provided supplemental data and information pertinent to the following subjects: enrollment, facilities, finance, personnel, transportation, and educational programs.*
- Documentation of all hearings, motions, written public comments, a synopsis or transcript of verbal comments, and other actions concerning the proposed school closings and consolidations were provided in this document.*
- All hearings were properly advertised with a class III legal advertisement.*

Thomas E. Williams, Jr., Ed.D.

Signature of county superintendent attesting to the completion of all requirements as stated in W. Va. Codes §18-5-13 and §18-5-13a and WVBE Policies 6200 and 6204.

Superintendent

5-8-2023
Date

Appendix of Supporting Data

County Procedures

9. Certified Enrollment for Kanawha County Board of Education

Most current October 1st certified enrollment:

**KANAWHA COUNTY SCHOOLS 2022 ENROLLMENT PROJECTIONS
BASED UPON SECOND MONTH ENROLLMENT DATA
GRADES K-12, SPECIAL ED INCLUDED**

SCHOOL NAME	GRADE GROUP	2022-23 ACTUAL	2023-24 PROJ.	2024-25 PROJ.	2025-26 PROJ.	2026-27 PROJ.	2027-28 PROJ.	2028-29 PROJ.	2029-30 PROJ.	2030-31 PROJ.	2031-32 PROJ.	2032-33 PROJ.
ELEMENTARY SCHOOLS												
ALBAN	(P-5)	255	225	206	208	200	196	202	203	207	212	217
ALUM CREEK	(P-5)	159	151	137	131	129	130	131	132	134	136	138
ANDREWS HEIGHTS	(P-5)	263	246	224	219	219	215	225	227	230	234	237
ANNE BAILEY	(P-5)	217	225	229	232	224	226	232	233	236	239	242
BELLE	(P-5)	291	280	274	271	260	250	255	256	259	263	267
BRIDGEVIEW	(P-5)	422	395	375	356	349	347	359	362	368	376	382
CEDAR GROVE	(P-5)	168	143	121	115	110	110	112	113	115	117	119
CENTRAL	(P-5)	333	353	362	353	348	346	353	353	357	362	366
CHAMBERLAIN	(P-5)	213	218	218	204	200	199	200	199	201	203	205
CHESAPEAKE	(P-5)	115	114	112	115	117	107	106	106	107	108	109
CLENDENIN	(P-5)	300	293	269	257	248	236	243	243	245	249	251
CROSS LANES	(P-5)	310	299	290	283	276	282	294	298	304	310	315
DUNBAR PRIMARY	(P-5)	535	539	539	522	504	492	502	504	511	521	528
EDGEWOOD	(P-5)	378	381	382	372	373	367	378	379	384	391	396
ELK CENTER	(P-5)	491	441	422	408	401	394	409	411	417	424	430
FLINN	(P-4)	439	375	369	356	333	328	338	346	355	363	363
GRANDVIEW	(P-5)	174	165	162	154	150	147	151	152	154	157	159
HOLZ	(P-5)	279	263	257	262	244	241	243	242	245	250	253
KANAWHA CITY	(P-5)	245	232	227	212	211	203	211	212	215	219	222
KENNA	(P-5)	166	158	159	156	153	153	156	156	157	159	160
LAKEWOOD	(P-5)	288	289	284	279	275	273	282	284	288	293	297
MALDEN	(P-5)	152	114	106	102	99	96	103	104	107	110	113
MARMET	(P-5)	112	104	99	95	94	91	94	94	95	97	99

**KANAWHA COUNTY SCHOOLS 2022 ENROLLMENT PROJECTIONS
BASED UPON SECOND MONTH ENROLLMENT DATA
GRADES K-12, SPECIAL ED INCLUDED**

SCHOOL NAME	GRADE GROUP	2022-23 ACTUAL	2023-24 PROJ.	2024-25 PROJ.	2025-26 PROJ.	2026-27 PROJ.	2027-28 PROJ.	2028-29 PROJ.	2029-30 PROJ.	2030-31 PROJ.	2031-32 PROJ.	2032-33 PROJ.
MARY INGLES	(P-5)	135	141	138	132	127	130	136	136	138	140	142
MIDLAND TRAIL	(P-5)	155	144	133	123	119	120	121	122	123	126	127
MONTROSE	(P-5)	236	213	199	193	182	181	185	186	188	191	193
NITRO ELEM.	(P-5)	367	333	326	317	306	298	304	304	306	310	313
OVERBROOK	(P-5)	349	382	376	374	348	348	347	345	346	348	349
PIEDMONT	(P-5)	259	301	308	298	288	292	299	299	301	305	308
PINCH	(P-5)	321	340	337	329	326	313	320	322	326	333	338
PRAATT	(P-5)	161	137	134	128	121	119	122	123	125	128	129
PT. HARMONY	(P-5)	487	452	431	406	392	389	399	402	408	417	424
RICHMOND	(P-5)	223	236	237	225	229	227	236	239	243	248	252
RUFFNER	(P-5)	290	263	254	246	237	234	239	240	243	247	250
RUTHLAWN	(P-5)	226	246	237	240	236	229	234	234	237	241	244
SHARON DAWES	(P-5)	144	143	149	147	143	141	139	138	138	139	139
SHOALS	(P-5)	210	192	172	168	163	160	166	167	170	174	177
SISSONVILLE ELEM.	(P-4)	243	277	266	256	243	245	253	255	258	260	260
WEBERWOOD	(P-5)	261	245	247	239	231	235	241	243	248	254	259
WEIMER	(P-5)	138	133	126	121	117	118	121	122	124	127	129
WEST SIDE	(P-5)	353	314	298	292	283	279	288	291	296	301	306
ELEMENTARY SCHOOLS		10,863	10,495	10,191	9,896	9,608	9,487	9,729	9,777	9,909	10,082	10,207

**KANAWHA COUNTY SCHOOLS 2022 ENROLLMENT PROJECTIONS
BASED UPON SECOND MONTH ENROLLMENT DATA
GRADES K-12, SPECIAL ED INCLUDED**

SCHOOL NAME	GRADE GROUP	2022-23 ACTUAL	2023-24 PROJ.	2024-25 PROJ.	2025-26 PROJ.	2026-27 PROJ.	2027-28 PROJ.	2028-29 PROJ.	2029-30 PROJ.	2030-31 PROJ.	2031-32 PROJ.	2032-33 PROJ.
HIGH SCHOOLS												
CAPITAL HIGH	(9-12)	1,089	1,066	1,061	964	955	922	898	889	862	847	829
GEORGE WASHINGTON	(9-12)	1,198	1,193	1,159	1,059	1,035	1,047	1,022	1,057	1,053	1,029	1,055
HERBERT HOOVER HI	(9-12)	789	757	787	781	746	756	689	633	646	616	611
NITRO HIGH	(9-12)	827	802	775	716	674	651	631	632	601	576	556
RIVERSIDE HIGH	(9-12)	1,220	1,137	1,013	912	867	824	802	758	722	696	681
SISSONVILLE HIGH	(9-12)	563	576	545	541	521	495	492	473	481	469	455
SO. CHARLESTON HI	(9-12)	954	930	908	881	837	810	786	758	738	724	702
ST. ALBANS HIGH	(9-12)	993	992	1,040	1,008	970	950	869	844	823	796	808
HIGH SCHOOLS		7,633	7,453	7,288	6,862	6,605	6,455	6,189	6,044	5,926	5,753	5,697

**KANAWHA COUNTY SCHOOLS 2022 ENROLLMENT PROJECTIONS
BASED UPON SECOND MONTH ENROLLMENT DATA
GRADES K-12, SPECIAL ED INCLUDED**

SCHOOL NAME	GRADE GROUP	2022-23 ACTUAL	2023-24 PROJ.	2024-25 PROJ.	2025-26 PROJ.	2026-27 PROJ.	2027-28 PROJ.	2028-29 PROJ.	2029-30 PROJ.	2030-31 PROJ.	2031-32 PROJ.	2032-33 PROJ.
MIDDLE SCHOOLS												
ANDREW JACKSON	(6-8)	515	493	487	497	476	449	432	417	404	387	379
DUNBAR MIDDLE	(6-8)	300	296	288	296	290	297	290	285	266	256	251
DUPONT MIDDLE	(6-8)	423	404	422	386	364	335	327	311	298	286	280
EAST BANK MIDDLE	(6-8)	254	265	261	254	223	231	225	225	209	201	197
ELKVIEW MIDDLE	(6-8)	613	618	582	529	494	491	495	502	463	443	436
HAYES MIDDLE	(6-8)	436	435	431	408	384	379	393	392	378	363	356
HORACE MANN MID	(6-8)	399	387	356	382	366	375	363	367	352	336	326
JOHN ADAMS MIDL	(6-8)	705	689	725	698	723	696	728	699	683	656	641
MCKINLEY MIDDLE	(6-8)	303	279	261	235	231	218	228	226	218	208	204
SISSONVILLE MIDDLE	(5-8)	541	513	511	490	495	484	469	454	426	416	420
SOUTH CHARLESTON	(6-8)	352	351	338	327	302	285	276	278	273	262	256
WEST SIDE MID	(6-8)	377	364	366	360	330	318	317	314	299	286	280
MIDDLE SCHOOLS		5,218	5,094	5,028	4,862	4,678	4,558	4,543	4,470	4,269	4,100	4,026
Grand Total	KANAWHA COUNTY	23,714	23,042	22,507	21,620	20,891	20,500	20,461	20,291	20,104	19,935	19,930